

designLAB

UNIVERSITY of HOUSTON
GERALD D. HINES COLLEGE of ARCHITECTURE



UNIVERSITY of HOUSTON

EXTERIOR CAMPUS SIGN PROGRAM

DESIGN GUIDELINES

Update v.5 02.09.19

Creation Dates v.1 03.20.15 v.2 07.31.18 v.3 01.15.18 v.4 01.15.19

TOP VIEW

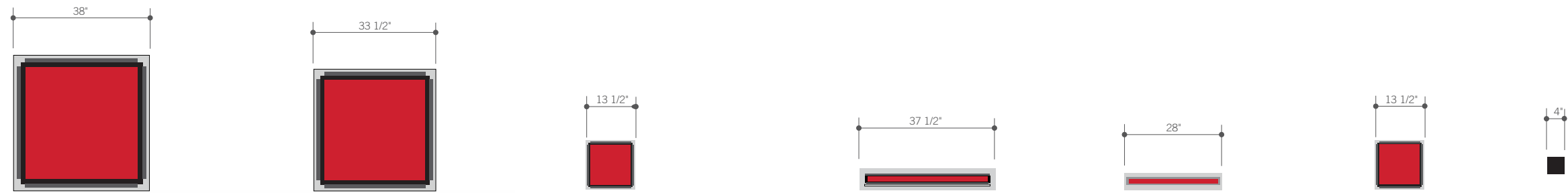

SIGN FAMILY

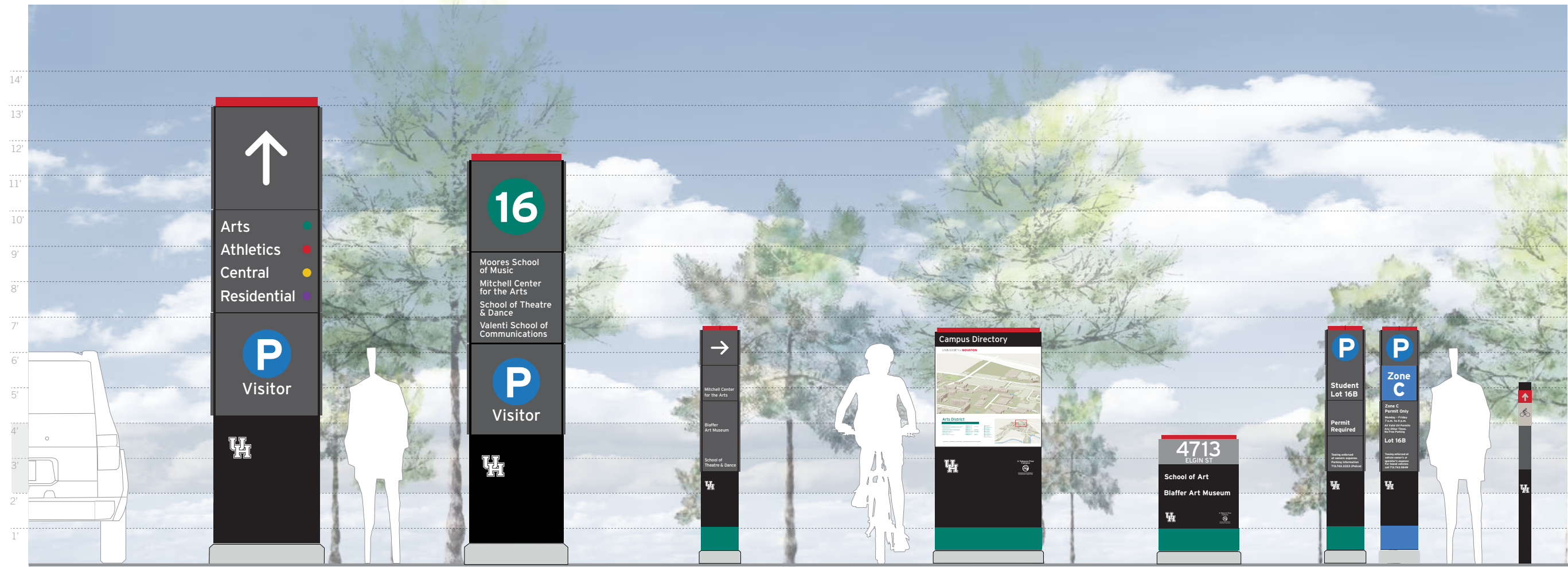

SIGN TYPE	Directional (Fast Traffic) Type A	Directional (Entrances and Campus Directionals - Slow Traffic) Type B	Directional (Pedestrian) Campus wayfinding Type C	Directory Kiosk (Pedestrian) Campus wayfinding Type D	Building Identifier Campus wayfinding Type E	Parking Identifier Parking lot entry markers Type F Type F.1	Trail Marker Campus wayfinding Type G
VISIBILITY METRICS							
PRODUCTION FEATURES	<ul style="list-style-type: none"> > 4 active message sides > Porcelain enamel faces and trim > Screen printed and vinyl graphics > Painted and UV coated frame structure > Graffiti-resistant surfaces > Changeable face panels for updating > Attachments, tamper proof hardware > Footing includes mow guard and pier construction for stability > Font family - Interstate 	<ul style="list-style-type: none"> > 4 active message sides > Porcelain enamel faces and trim > Screen printed and vinyl graphics > Painted and UV coated frame structure > Graffiti-resistant surfaces > Changeable face panels for updating > Attachments, tamper proof hardware > Footing includes mow guard and pier construction for stability > Font family - Interstate 	<ul style="list-style-type: none"> > 4 active message sides > Porcelain enamel faces and trim > Screen printed and vinyl graphics > Painted and UV coated frame structure > Graffiti-resistant surfaces > Changeable face panels for updating > Attachments, tamper proof hardware > Footing includes mow guard and pier construction for stability > Font family - Interstate 	<ul style="list-style-type: none"> > 2 active message sides > Porcelain enamel trim > Screen printed and vinyl graphics > Painted and UV coated frame structure > Graffiti-resistant surfaces > Attachments, tamper proof hardware > Footing includes mow guard and pier construction for stability > Font family - Interstate 	<ul style="list-style-type: none"> > 2 active message sides > Porcelain enamel trim > Screen printed and vinyl graphics > Painted and UV coated frame structure > Graffiti-resistant surfaces > Attachments, tamper proof hardware > Footing includes mow guard and pier construction for stability > Font family - Interstate 	<ul style="list-style-type: none"> > 4 active message sides > Porcelain enamel faces and trim > Screen printed and vinyl graphics > Painted and UV coated frame structure > Graffiti-resistant surfaces > Changeable face panels for updating > Attachments, tamper proof hardware > Footing includes mow guard and pier construction for stability > Font family - Interstate 	<ul style="list-style-type: none"> > 4 active message sides > Porcelain enamel faces and trim > Screen printed and vinyl graphics > Painted and UV coated frame structure > Graffiti-resistant surfaces > Changeable face panels for updating > Attachments, tamper proof hardware > Footing includes mow guard and pier construction for stability > Font family - Interstate

REFER TO UH PARKING SIGN PACKAGE v7 FOR CURRENT SIGNS

ISSUE	DATE
GUIDELINES	02.09.19

University of Houston
Campus Exterior Sign Program



DRAWN: MD
CHECKED: MD
SCALE: AS NOTED

Sign Family

GENERAL NOTES FOR FABRICATION AND INSTALLATION

THESE DRAWINGS REPRESENT DESIGN INTENT ONLY AND INDICATE THE INTENDED PRODUCT SIZES, MATERIALS, FINISHES, AND INSTALLATION. THE FABRICATOR IS REQUIRED TO PROVIDE SHOP DRAWINGS AND DETAILS FOR EACH SIGN TYPE, AND WHERE NECESSARY, TO PROVIDE DETAILED DRAWINGS STAMPED BY A LICENSED ENGINEER. SHOP DRAWINGS MUST BE APPROVED BY THE UNIVERSITY, UNIVERSITY'S REPRESENTATIVE, OR DESIGNER BEFORE FABRICATION.

1. Written dimensions on these drawings have precedence over scaled dimensions.

2. All sign copy should be considered to be representative and is subject to change. Refer to final approved message schedule for final copy on all signs.

3. The Fabricator or Installer shall notify the University representative of any discrepancies in these documents immediately and shall not proceed or allow sub-fabricators to work in those areas until said discrepancies are resolved.

4. Fabricator is to submit shop drawings for all sign types including fabrication details, foundation and installation specifications, etc. sufficient to demonstrate the design intent of the drawings. Shop drawings shall be submitted to the University representative for approval prior to fabrication.

5. Fabricator shall conform to the intent of these drawings and specifications and submit to the University representative samples for all finishes included in the scope of work before commencement of such work.

6. Fabricator shall be responsible for all required fees and permits for the fabrication and installation of signs and shall procure these before proceeding with work.

7. All work shall be done in accordance with all applicable codes and to the highest standards of trade practice. All sign components are to be straight, square, and true to one another. All material joints and seams are to be fabricated so that joints and seams are unnoticeable.

8. The Fabricator shall provide all engineering and stamped drawings required for exterior signage, guaranteed for local conditions.

9. Prior to commencing any work, the Fabricator or Installer who is awarded all or part of fabrication and/or installation shall review with the Owner and Architect the phasing of their work. The schedule should be submitted and approved by all parties.

10. The Fabricator shall warrant that all merchandise is free of defects in material or workmanship and shall provide Owner with a warranty to replace or repair any merchandise that fails to conform to above for a period of no less than one (1) year from date of final acceptance.

11. The Fabricator shall stake or mark all locations for approval by Owner. The fabricator shall coordinate location verification with all underground facilities.

12. All hangers, channels, rods and other miscellaneous support steel shall be installed as necessary for the support of suspended equipment (signage) and shall be fastened to the existing structure in such a manner as to not compromise its existing structural integrity or fire rating.

13. The Installer shall keep the site work area(s) clear of unnecessary debris and shall keep all work area(s) secured when unattended for the duration of the installation period.

14. The Fabricator shall provide removal, backfilling and proper disposal of existing signs at locations of new signs.

15. The Installer shall clean the site of all unnecessary debris and clean all glass, chrome, and any other items before vacating the site and final Owner sign-off.

16. The documents reflect the best efforts to interpret and apply standards established by the Americans with Disabilities Act of 1991 and as set forth by the Opportunities Commission and the Department of Justice. The University will not be held responsible for the interpretation of ADA Laws by others.

PROJECT MATERIALS

M1 Material Porcelain Enamel	M4 Material HPL Panel (IZONE)
M2 Material Aluminum	M5 Material Digital Printed Vinyl
M3 Material Concrete	

PROJECT COLORS

P1 Paint red MP 12602 satin	P8 Paint teal PMS 7717 satin	V1 Vinyl, White Avery 900 Supercast Opaque High Tac Adhesive (<i>no substitutes</i>)
P2 Paint D grey MP 10124 satin	P9 Paint L blue PMS 660 satin	V2 Vinyl, Black 3M 220 Matte Black
P3 Paint L grey MP 03340 satin	P10 Paint tan PMS 7503 satin	V3 Vinyl, Blue HC 3M 220 Olympic Blue
P4 Paint black MP 33764 satin	P11 Paint purple PMS 259 satin	V4 Vinyl, Oracal 851 Premium Cast 019 Signal Yellow
P5 Paint white MP 32071 satin	P12 Paint yellow PMS 7406 satin	V5 Vinyl, Avery 900 Supercast Opaque Spectra Everglade
P6 Paint magenta satin PMS 220	P13 Paint HC blue satin PMS 2925	V6 Vinyl, 3M 220 Periwinkle
P7 Paint green PMS 7496 satin		V7 Vinyl, 3M 220 Tan
		V8 Vinyl, Oracal 851 Premium Cast 415 Summer Plum
		V9 Vinyl, 3M 220 Raspberry
		V10 Vinyl, Avery 900 Supercast Opaque Olive Green
		V11 Vinyl, 3M 220 Geranium
		P1 Porcelain Match MP 12602
		P2 Porcelain Match MP 10124

Remote Campus - UH Sugar Land UH Katy

P3 Paint MP 03340 satin
V12 Vinyl, Oracal 851 Premium Cast 730 Simple Grey

DISTRICT COLORS

- P1** Athletics
- P6** Health
- P7** Energy
- P8** Arts
- P9** Professional
- P10** Cullen North
- P11** Residential
- P12** Central

PROJECT TYPEFACE Interstate Regular

abcdefghijklmnopqrstuvwxy
 ABCDEFGHIJKLMNOPQRSTUVWXYZ
 1234567890

Interstate Bold

abcdefghijklmnopqrstuvwxy
 ABCDEFGHIJKLMNOPQRSTUVWXYZ
 1234567890

PROJECT SYMBOLS

Interlocking Logo

Visitor Parking

Patient Parking

Information

Arrow



reversed against black field
electronic files provided by Owner



Visitor



Patient



Information

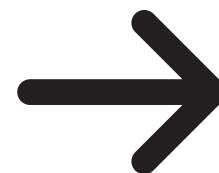

A Tobacco-Free Campus



Smoking is Prohibited
Including E-Cigarettes

ISSUE	DATE
GUIDELINES	02.09.19

University of Houston
Campus Exterior Sign Program



DRAWN: MD
 CHECKED: MD
 SCALE: AS NOTED

Overview

Colors/ Materials/ Type/
Symbols



OWNER TO PROVIDE:
 ■ Digital files for all artwork
 (Adobe Illustrator CC)

SIGN CONTRACTOR TO PROVIDE:
 ■ Shop Drawings
 ■ Engineering Calculations
 ■ Paint and Porcelain samples on 1/8" aluminum/steel,
 4"x6"(QTY: 3)
 ■ In production review
 ■ Fabricator to verify field conditions prior to fabrication

- Aluminum cabinet with surface applied message panels. Sign Contractor responsible for determining internal structure for support. Base painted to match indicated color, painted surfaces to be clear coated, satin finish.
- 1/16" thick porcelain pan cap attached to angle mounting brackets. Pan head screws to be painted to match end cap.
- 3/4" deep, 1/16" thick porcelain pan faces attached to angle mounting brackets. Mount panels to angles with countersunk, tamper proof mechanical fasteners, painted to match adjacent surface color. Mounting holes are to be drilled on panel edges prior to porcelain enamel application.
- Surface mounted aluminum angles for mounting of panels.
- Isolate dissimilar metals.
- Surface applied high performance vinyl. Arrows, text and graphics.
- UH logo, cut applied vinyl to sign face (all sides)
- Internal structure to be secured to concrete footing with appropriate mechanical fasteners.
- Sign Contractor to determine and provide engineered concrete foundation/footing to withstand 110 mph wind loads and local weather conditions. Engineered drawing required. Min. 6' 6" piers.
- 1/2" wide, 45° bevel on all exposed footing edges.
- 20" reinforced concrete mow guard flush with existing grade.

2 Plan View
Scale: as shown

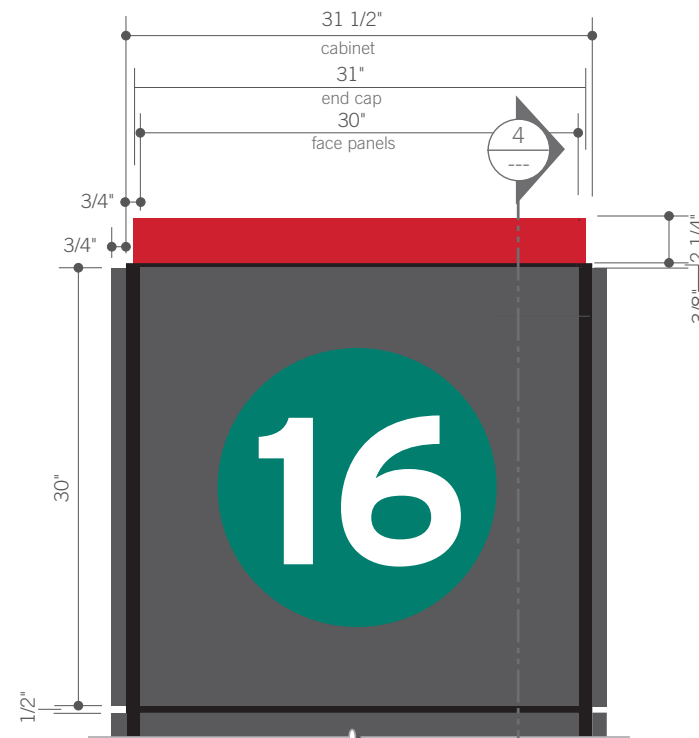
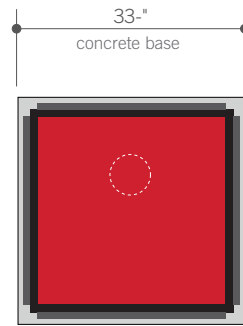

3 DETAIL - Panel
Scale: as shown

4 SECTION DETAIL
Scale: as shown

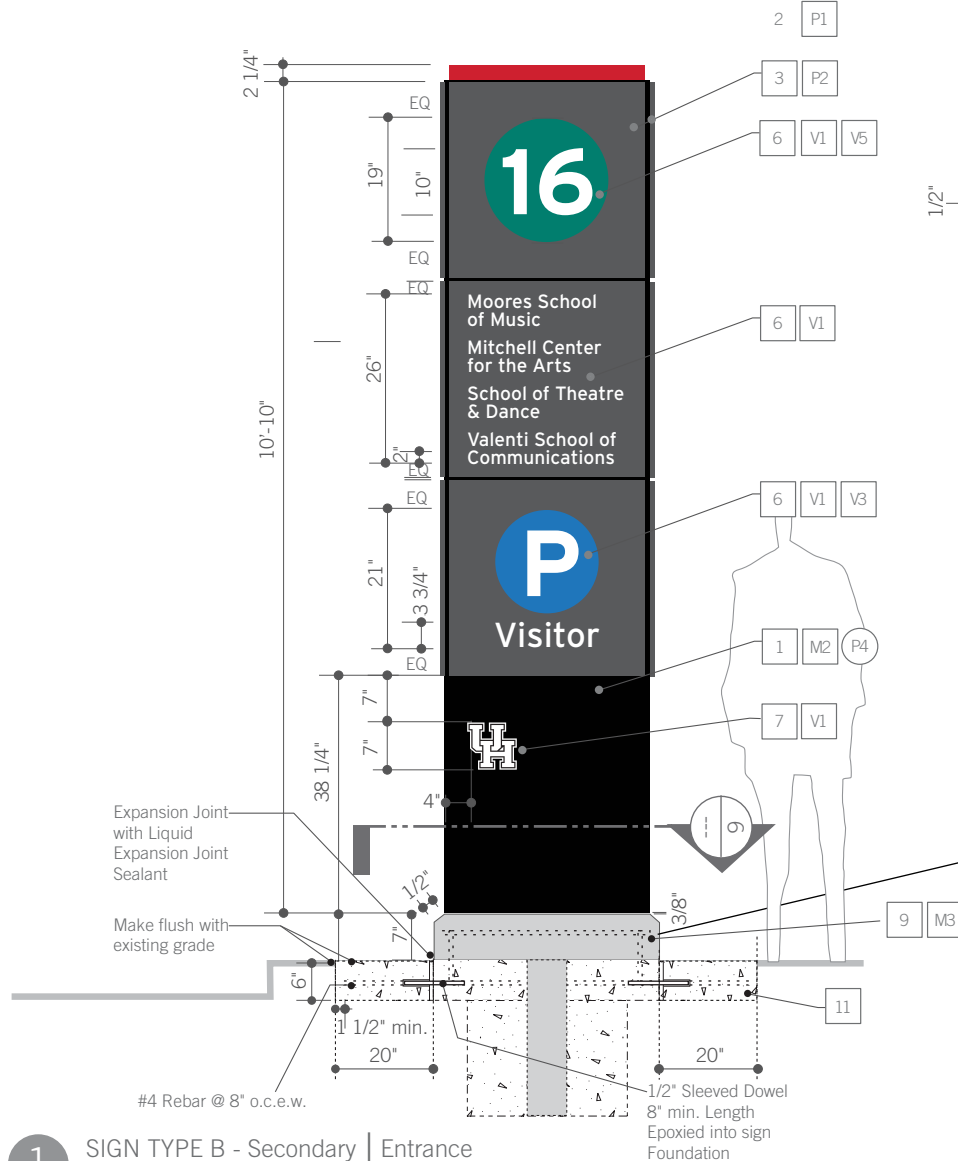
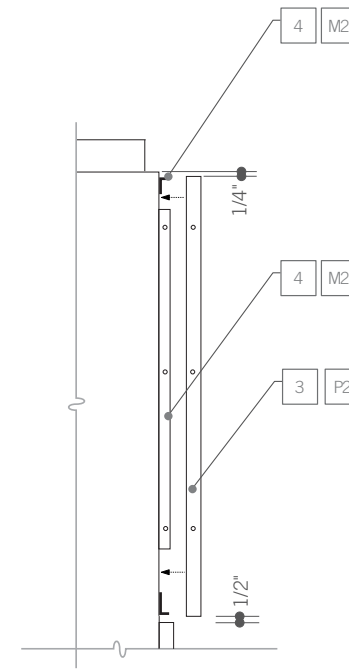

1 SIGN TYPE B - Secondary | Entrance
Scale: as shown

5 DETAIL - Footing
Scale: as shown

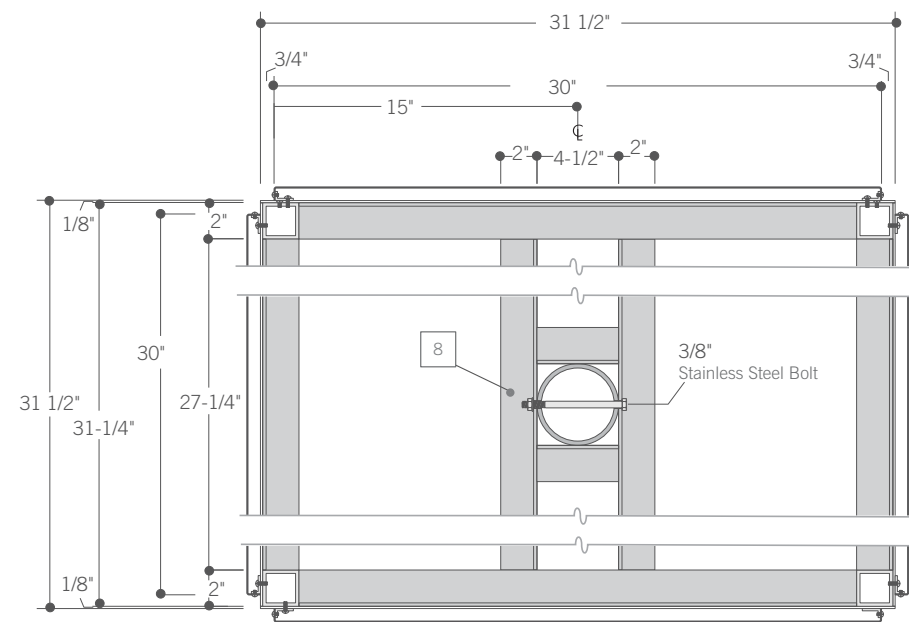
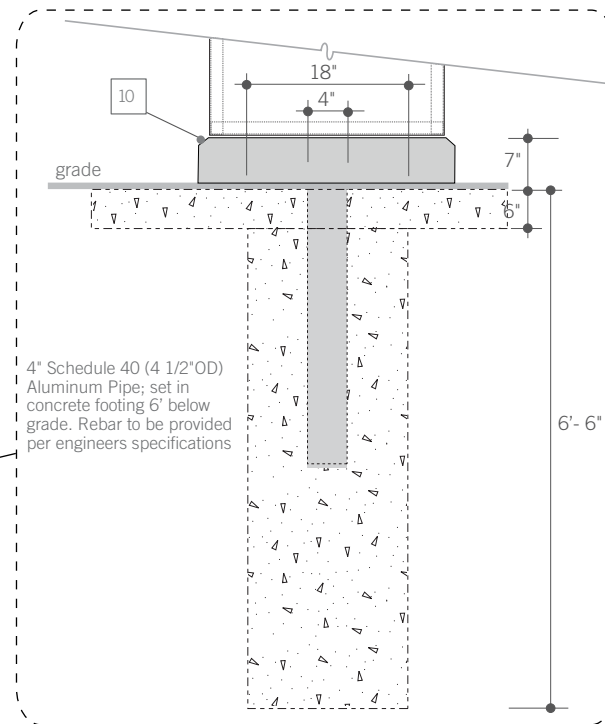

6 SECTION DETAIL PLAN VIEW
Scale: as shown

ISSUE	DATE
GUIDELINES	02.09.19

University of Houston
Campus Exterior Sign Program



DRAWN: MD
CHECKED: MD
SCALE: AS NOTED

Sign Type
C
Pedestrian Directional

OWNER TO PROVIDE:
■ Digital files for all artwork
(Adobe Illustrator CC)

SIGN CONTRACTOR TO PROVIDE:
■ Shop Drawings
■ Engineering Calculations
■ Paint and Porcelain samples on 1/8" aluminum/steel,
4"x6"(QTY: 3)
■ In production review
■ Fabricator to verify field conditions prior to fabrication

- Aluminum cabinet with surface applied message panels. Sign Contractor responsible for determining internal structure for support. Base painted to match indicated color, painted surfaces to be clear coated, satin finish.
- 1/16" thick porcelain pan cap attached to angle mounting brackets. Pan head screws to be painted to match end cap.
- 1/2" deep, 1/16" thick porcelain pan faces attached to angle mounting brackets. Mount panels to angles with countersunk, tamper proof mechanical fasteners, painted to match adjacent surface color. Mounting holes are to be drilled on panel edges prior to porcelain enamel application.
- Surface mounted aluminum angles for mounting of panels.
- Isolate dissimilar metals.
- Surface applied high performance vinyl. Arrows, text and graphics.
- UH logo, cut applied vinyl to sign face (all sides)
- Internal structure to be secured to concrete footing with appropriate mechanical fasteners.
- Sign Contractor to determine and provide engineered concrete foundation/footing to withstand 110 mph wind loads and local weather conditions. Min. 6' piers.
- 1/2" wide, 45° bevel on all exposed footing edges.
- Mask and paint color band to match color indicated.
- 12" reinforced concrete mow guard flush with existing grade.

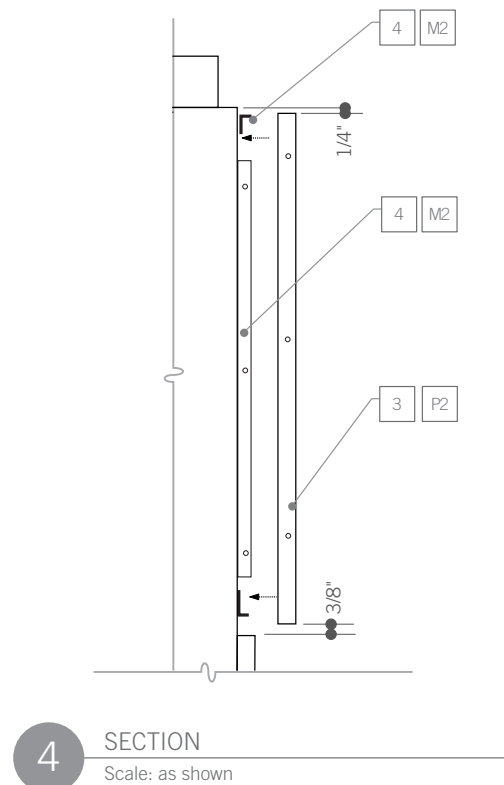
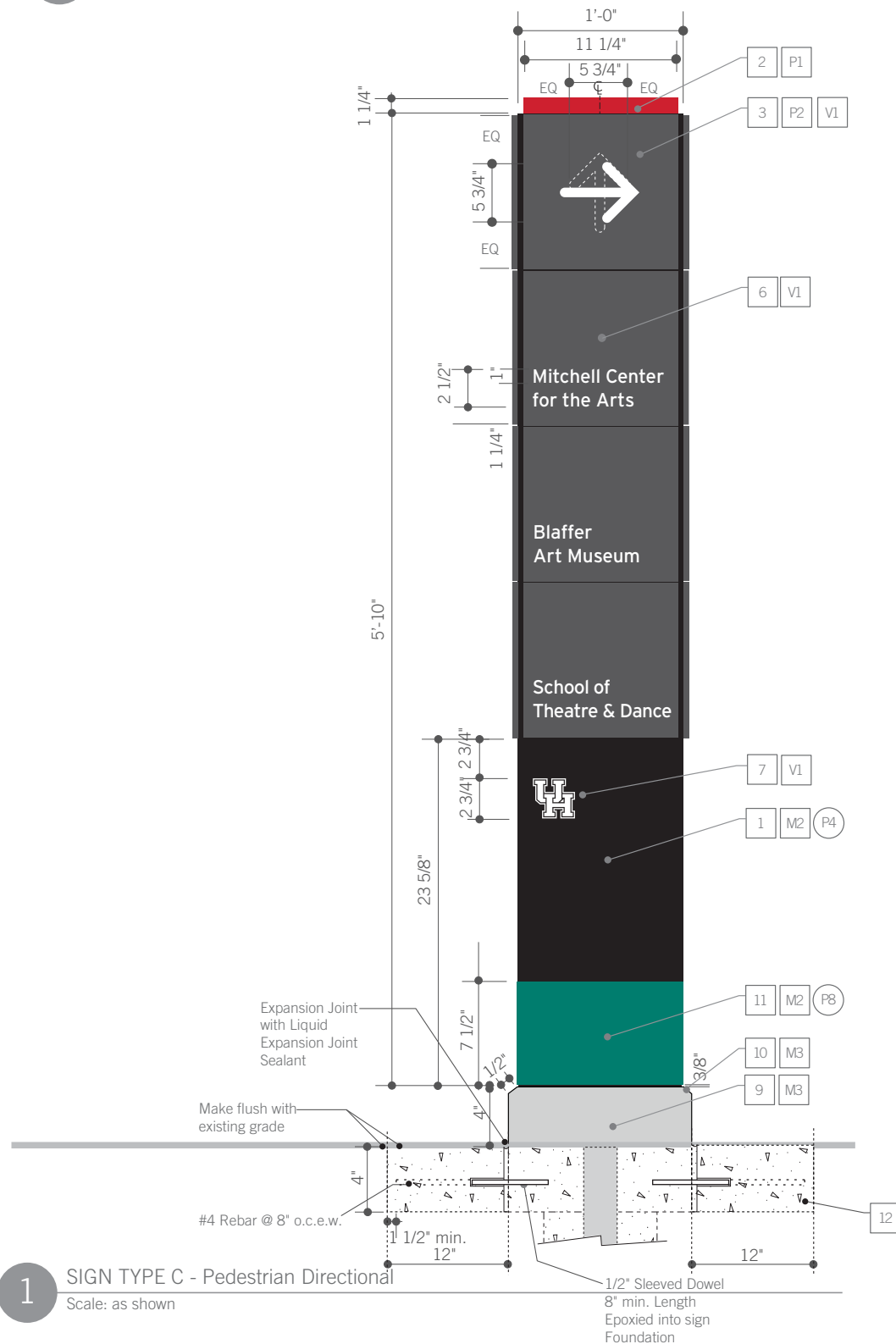
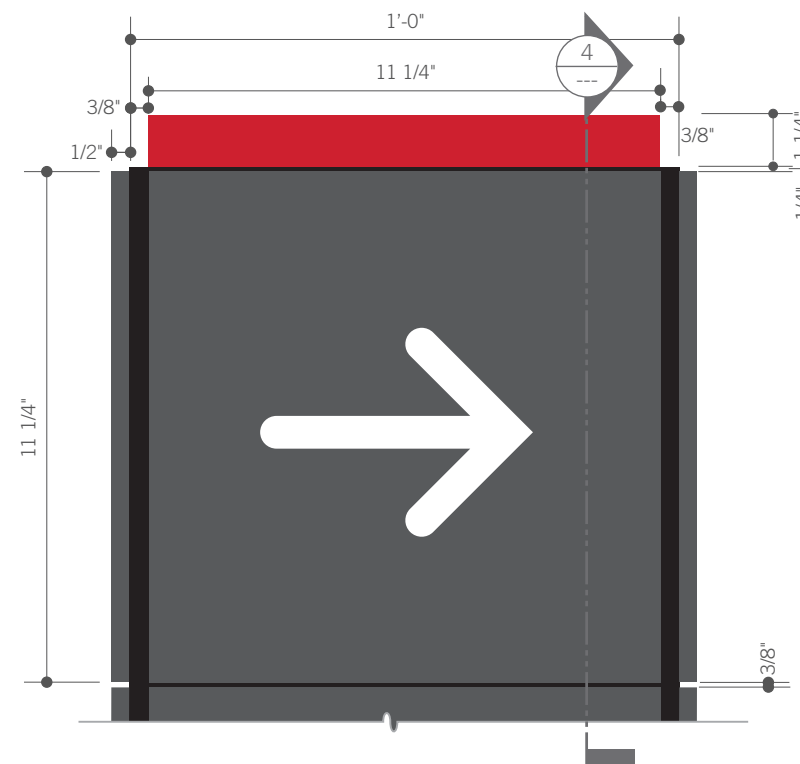
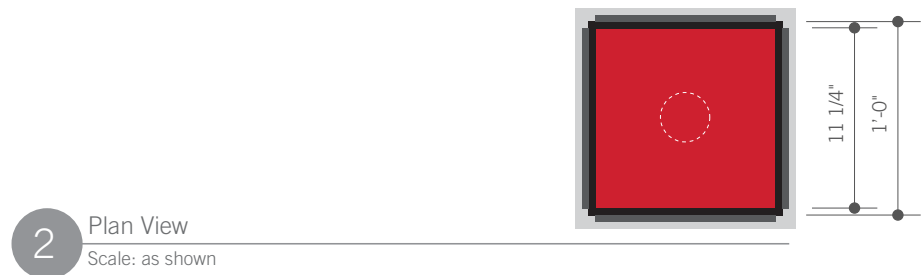

OWNER TO PROVIDE:
 ■ Digital files for all artwork
 (Adobe Illustrator CC)

SIGN CONTRACTOR TO PROVIDE:
 ■ Shop Drawings
 ■ Engineering Calculations
 ■ Paint and Porcelain samples on 1/8" aluminum/steel,
 4"x6"(QTY: 3)
 ■ In production review
 ■ Fabricator to verify field conditions prior to fabrication

1. Aluminum, thin profile pylon with applied 1/2" HPL panel (IZONE). Panel to be attached to sign face with undersized, 1/2" black spacer.
2. 1/16" thick porcelain pan cap attached to angle mounting brackets. Pan head screws to be painted to match end cap.
3. Surface mounted aluminum angles for mounting of panels.
4. Isolate dissimilar metals.
5. Surface applied high performance vinyl.
6. UH logo, cut applied vinyl to sign face (all sides)
Smoke Free message to be screen printed (white)
7. Internal structure to be secured to concrete footing with appropriate mechanical fasteners.
8. Sign Contractor to determine and provide engineered concrete foundation/footing to withstand 110 mph wind loads and local weather conditions. Min. 6' piers.
9. 1/2" wide, 45° bevel on all exposed footing edges.
10. Mask and paint color band to match color indicated.
11. 12" reinforced concrete mow guard flush with existing grade.

ISSUE	DATE
GUIDELINES	02.09.19

University of Houston
Campus Exterior Sign Program



DRAWN: MD
 CHECKED: MD
 SCALE: AS NOTED

Sign Type
D
 Pedestrian Directory
 Double-Sided

DRAWING FOR DESIGN INTENT ONLY.
 NOT INTENDED FOR CONSTRUCTION.

3 Plan View
 Scale: as shown

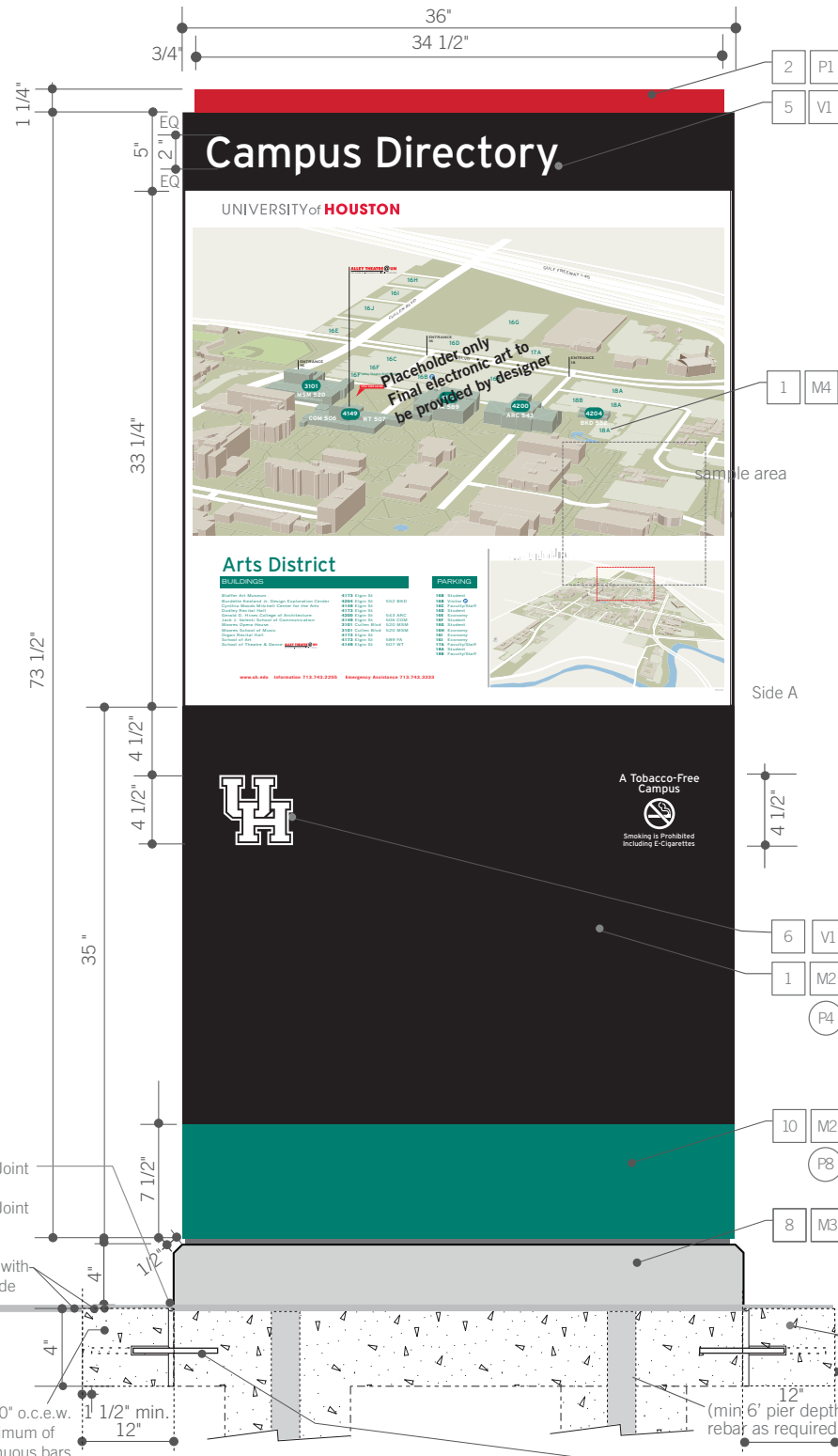

1 SIGN TYPE D - Pedestrian Directory
 Scale: as shown

Fabricator to verify depth to meet structural requirements



2 SIDE VIEW
 Scale: as shown

4 SIGN BACK
 Scale: as shown

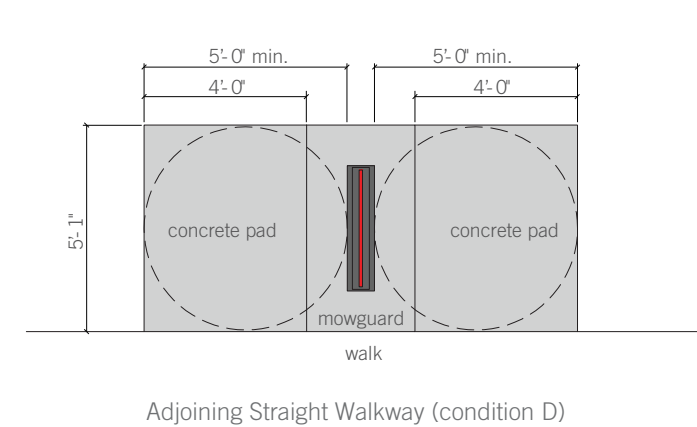
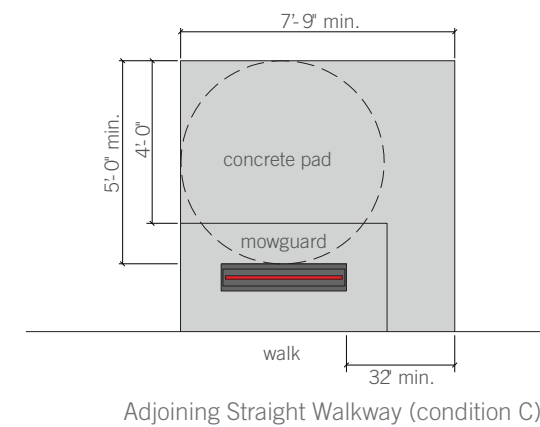
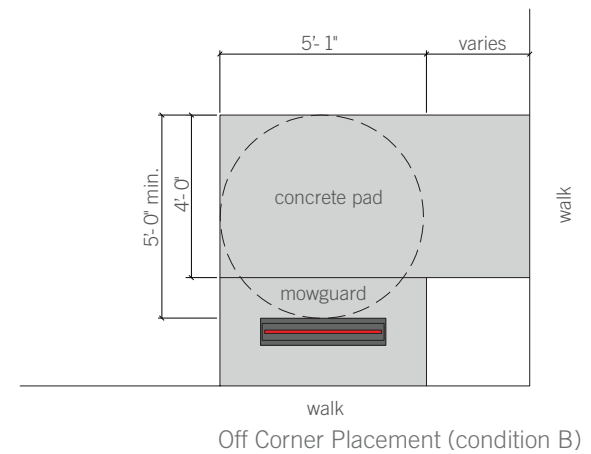
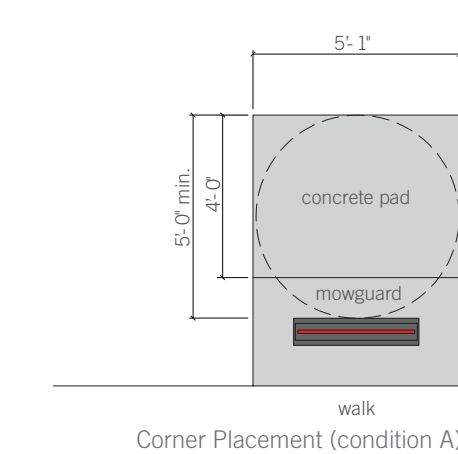
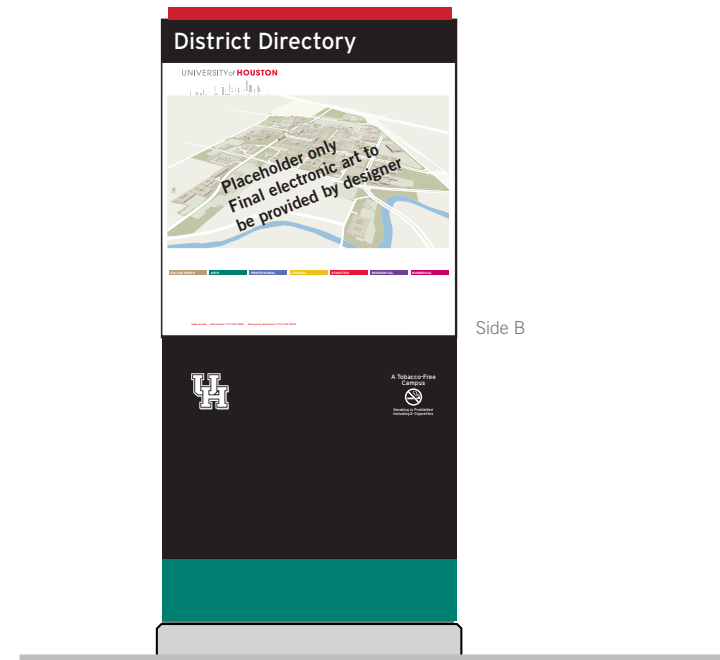

5 DETAIL - Installation Pad Variations - Accessibility
 Scale: as shown

#4 Rebar @ 10" o.c.e.w. provide a minimum of (3) - #4 continuous bars

Expansion Joint with Liquid Expansion Joint Sealant
 Make flush with existing grade

1 1/2" min. 12"

(min; 6' pier depth) rebar as required

1/2" Sleeved Dowel 8" min. Length Epoxied into sign Foundation

2 Plan View
Scale: as shown

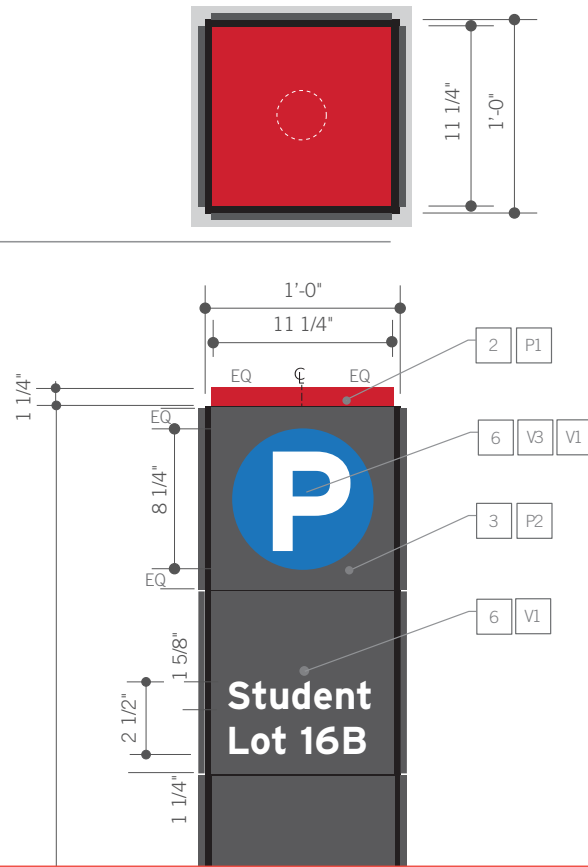

3 DETAIL - Panel
Scale: as shown

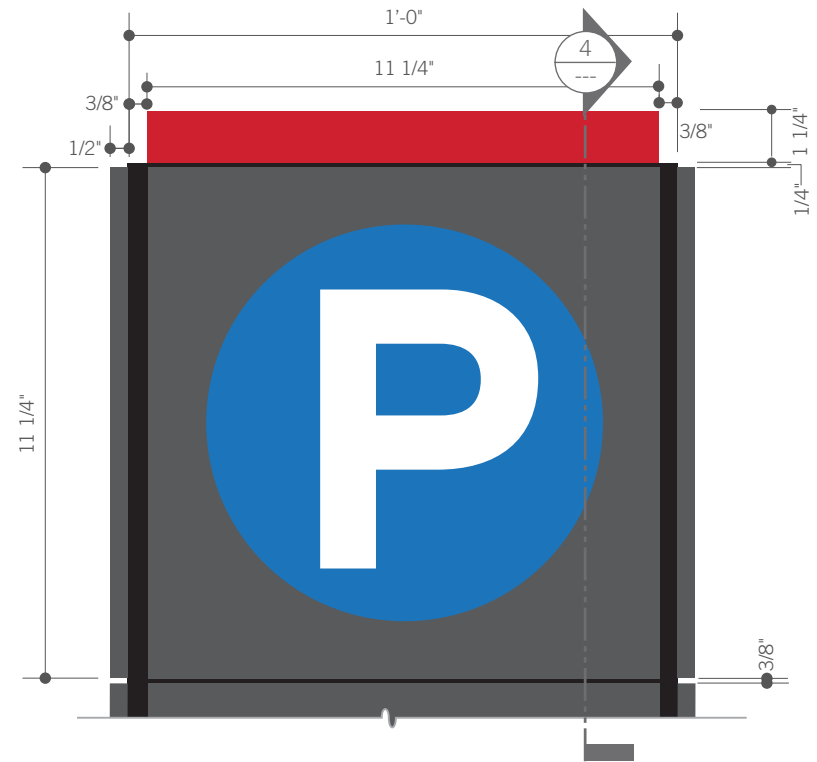

- OWNER TO PROVIDE:
- Digital files for all artwork (Adobe Illustrator CC)
- SIGN CONTRACTOR TO PROVIDE:
- Shop Drawings
 - Engineering Calculations
 - Paint and Porcelain samples on 1/8" aluminum/steel, 4"x6"(QTY: 3)
 - In production review
 - Fabricator to verify field conditions prior to fabrication

1. Aluminum cabinet with surface applied message panels. Sign Contractor responsible for determining internal structure for support. Base painted to match indicated color, painted surfaces to be clear coated, satin finish.
2. 1/16" thick porcelain pan cap attached to angle mounting brackets. Pan head screws to be painted to match end cap.
3. 1/2" deep, 1/16" thick porcelain pan faces attached to angle mounting brackets. Mount panels to angles with countersunk, tamper proof mechanical fasteners, painted to match adjacent surface color. Mounting holes are to be drilled on panel edges prior to porcelain enamel application.
4. Surface mounted aluminum angles for mounting of panels.
5. Isolate dissimilar metals.
6. Surface applied high performance vinyl. Arrows, text and graphics
7. UH logo, cut applied vinyl to sign face (all sides)
8. Internal structure to be secured to concrete footing with appropriate mechanical fasteners.
9. Sign Contractor to determine and provide engineered concrete foundation/footing to withstand 110 mph wind loads and local weather conditions. Min. 6' piers.
10. 1/2" wide, 45° bevel on all exposed footing edges.
11. Mask and paint color band to match color indicated.
12. 12" reinforced concrete mow guard flush with existing grade.

ISSUE	DATE
GUIDELINES	02.09.19

REFER TO UH PARKING SIGN PACKAGE 4.25.19 FOR CURRENT SIGNS

1 SIGN TYPE F - Parking Identifier
Scale: as shown

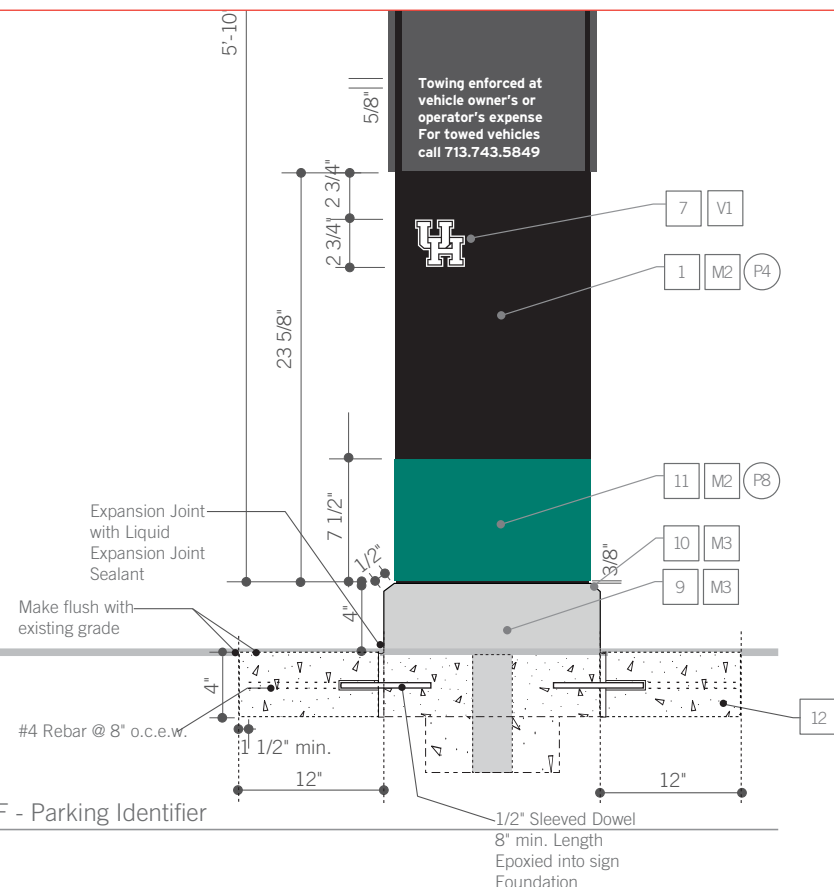

4 SECTION
Scale: as shown

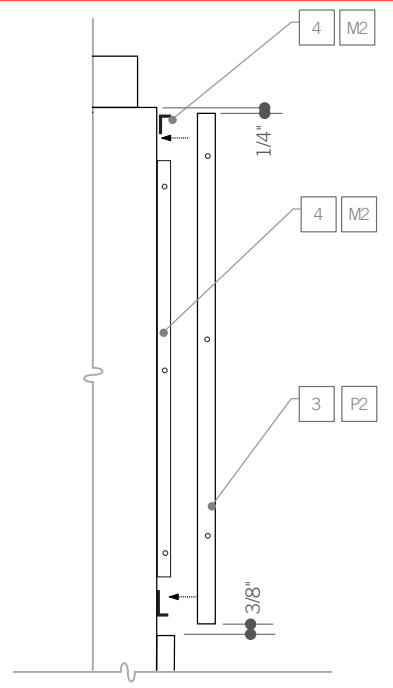

OWNER TO PROVIDE:
 ■ Digital files for all artwork
 (Adobe Illustrator CC)

SIGN CONTRACTOR TO PROVIDE:
 ■ Shop Drawings
 ■ Engineering Calculations
 ■ Paint and Porcelain samples on 1/8" aluminum/steel,
 4"x6"(QTY: 3)
 ■ In production review
 ■ Fabricator to verify field conditions prior to fabrication

1. Aluminum square tube. Sign Contractor responsible for determining internal structure for support. Base painted to match indicated color, painted surfaces to be clear coated, satin finish.
2. 1/4" thick aluminum sleeve. Printed High Performance vinyl graphics applied to 4 sides
3. 12" concrete mow guard surround.
4. UH logo, cut applied vinyl to sign face (all sides)
5. Sign Contractor to determine and provide engineered concrete foundation/footing to withstand local conditions. Min. 36" footing depth.

ISSUE	DATE
GUIDELINES	02.09.19

University of Houston
Campus Exterior Sign Program



DRAWN: MDG
 CHECKED: MDG
 SCALE: As noted
 MD PROJECT NO: 113-013

Sign Type
G
 Trail Marker

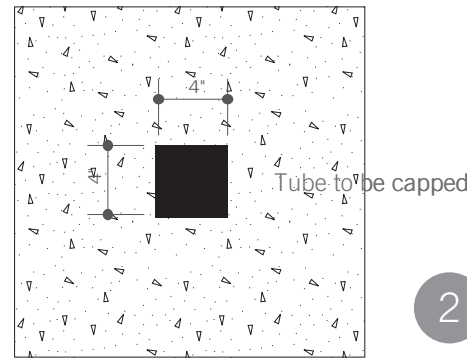

2 PLAN VIEW Trail Marker
 Scale: as shown

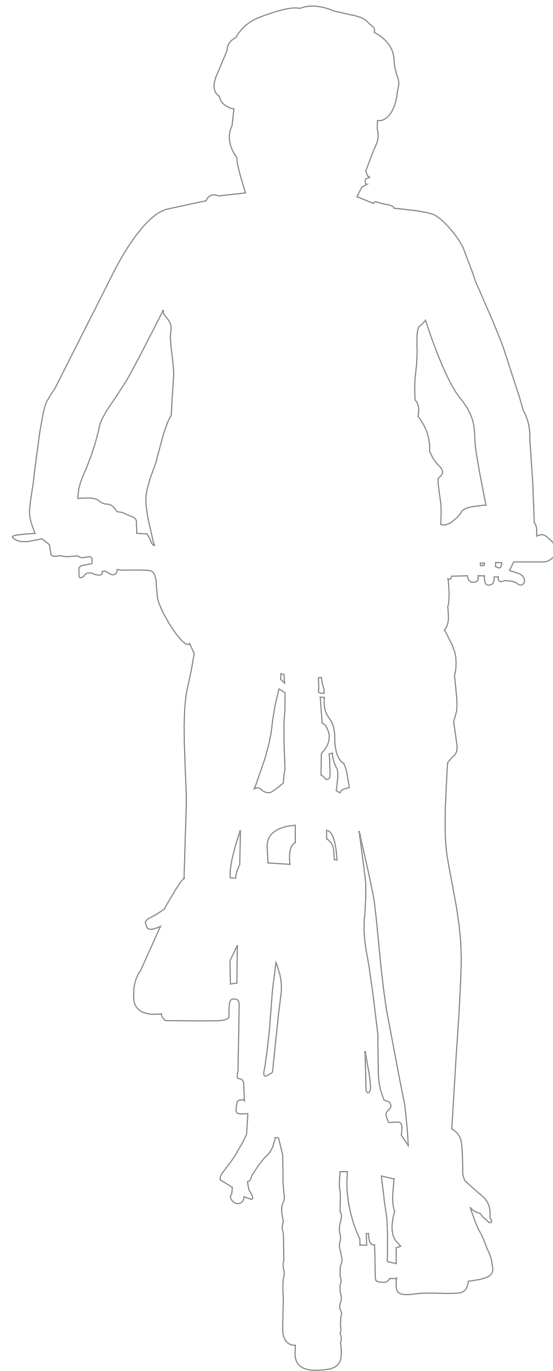

1 SIGN TYPE G Trail Marker
 Scale: as shown

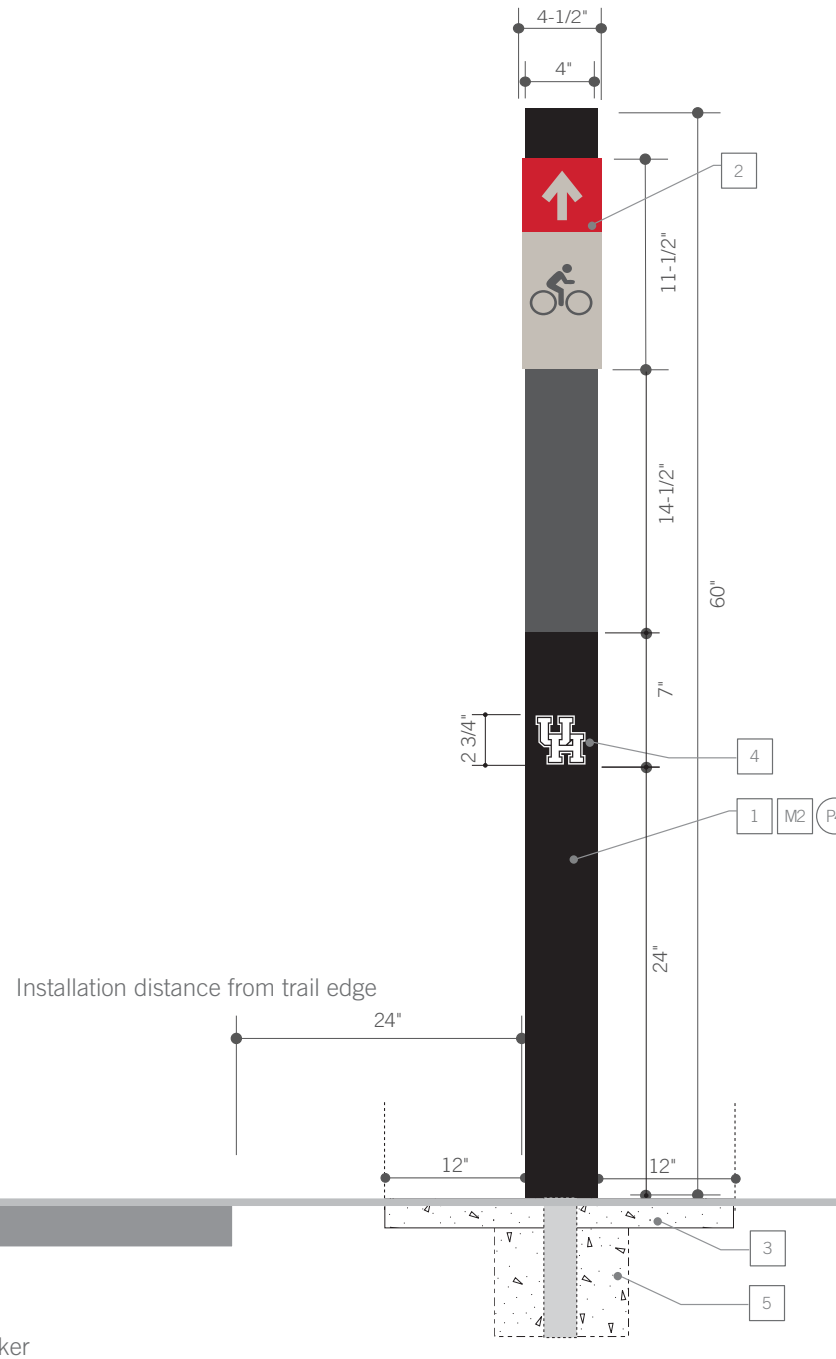

3

5

4

1

M2

P4

2

Fabricators Warranty - 1 year from date of installation
All stated component life cycles are from date of purchase

Final wear cycle dependant upon sign postioning, sun and exposure to elements.

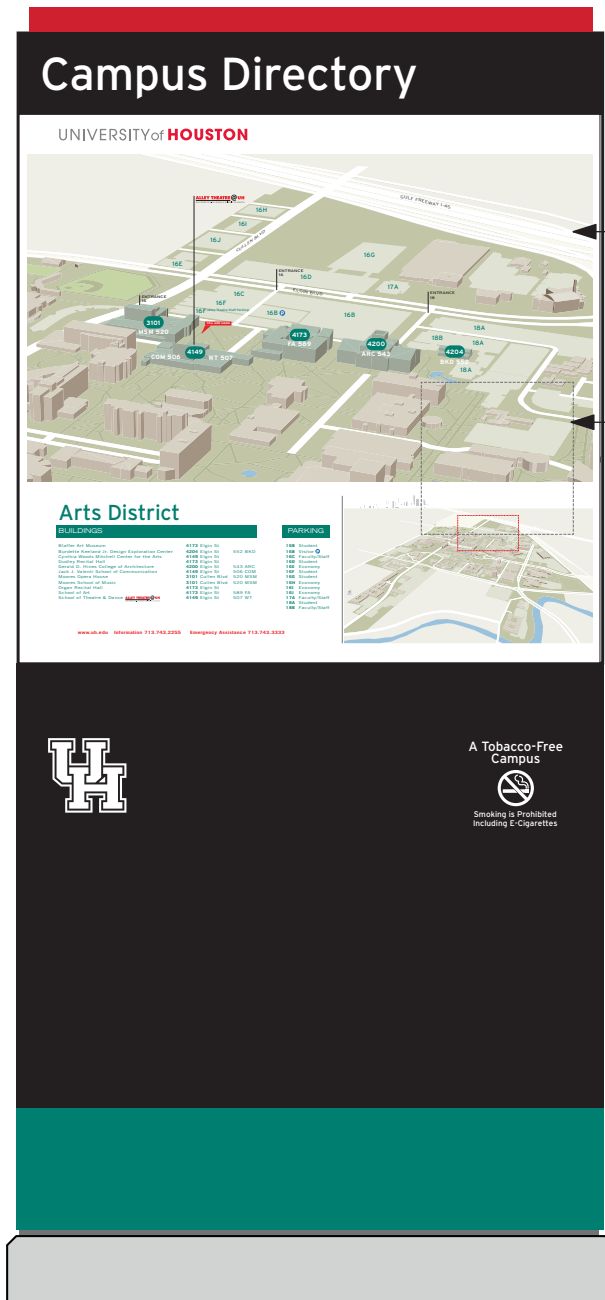
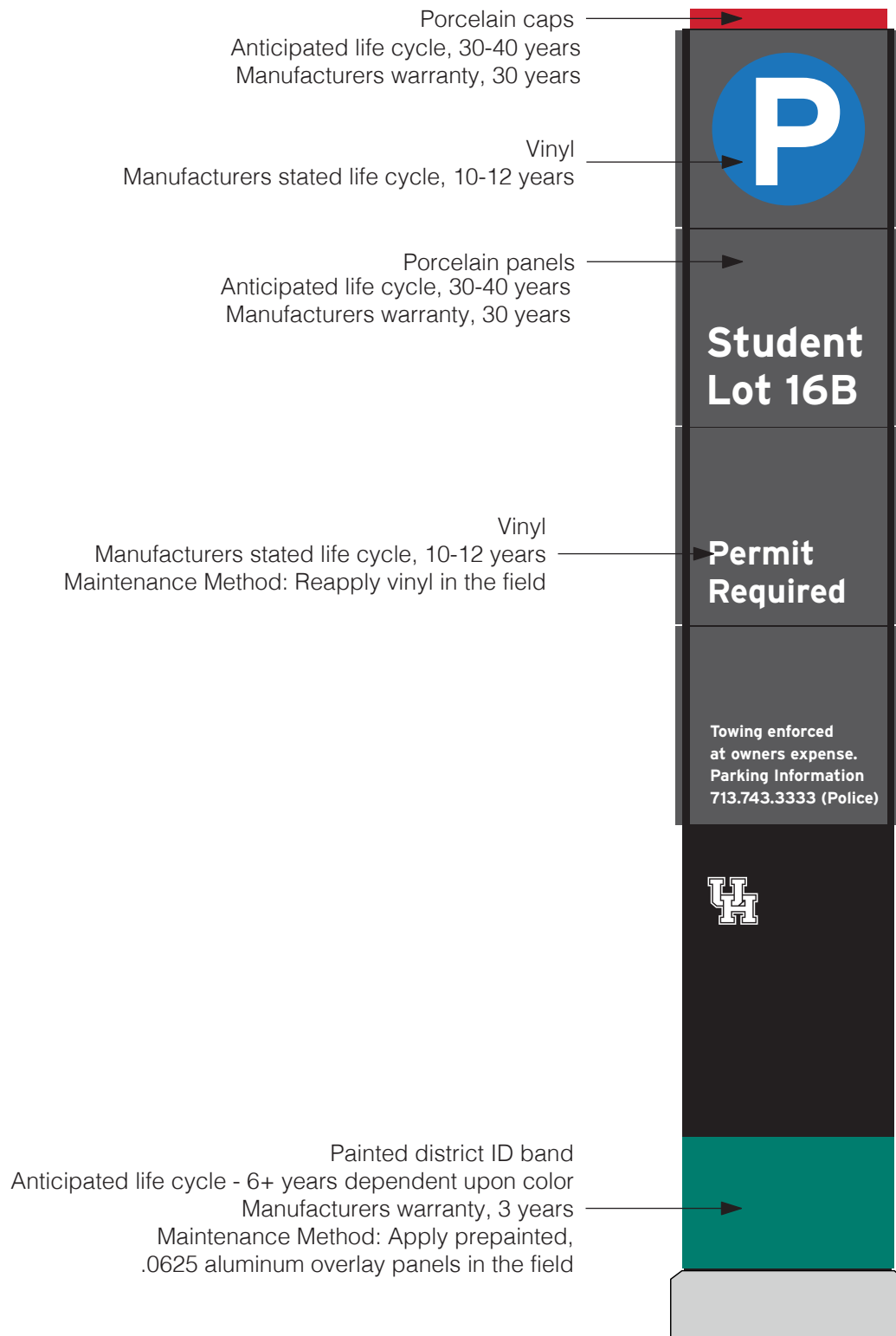

Representative sign types shown. Conditions apply to entire sign family.



DRAWN: MDG
CHECKED: MD
SCALE: AS NOTED

Maintenance and Aging Profile