

PhD in Communication Sciences & Disorders



UNIVERSITY of **HOUSTON**

COLLEGE of LIBERAL ARTS & SOCIAL SCIENCES

Communication Sciences & Disorders

About Houston

- Fourth largest city
- Access to a diverse population
- 45% speak a language other than English at home
- In 2019- 42% Hispanic, 31% White, 17% Black, 8% Asian, 2% other
- Close to 20 school districts
- World's largest medical center



About UH



UH AT A GLANCE

47,000+

Students

2,800+

Faculty

250

Undergrad Majors @ Minors

108

Master's Degrees

50

Doctoral @ Professional Degrees

37

Research Centers

What to do with a PhD

Research doctorate

- Academic position
 - Tenure track
 - Research emphasis
 - Teaching emphasis
 - Non-tenure track
 - Teaching emphasis
 - Clinical/Service position
- Clinical researcher
- Scientist



About the Program

First cohort in Fall
2020

Expanding
program with
more students and
new faculty

Only program in
the Greater
Houston area

Individualized
mentoring

Goal is to prepare
researchers and
scholars

Can be completed
full-time or part-
time

Melcher Life Sciences

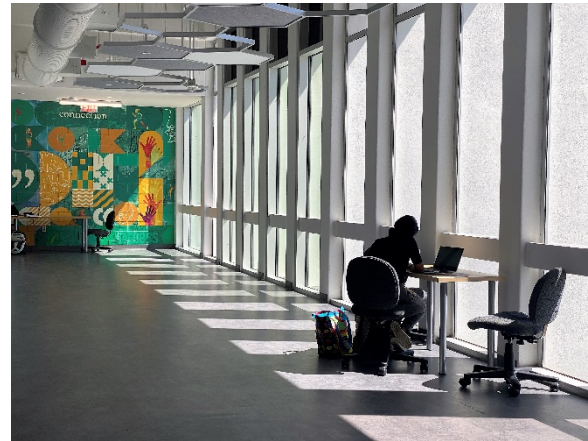

Program Requirements



COURSEWORK



INITIAL RESEARCH
PROJECT



COMPREHENSIVE
EXAM



TEACHING
EXPERIENCE



RESEARCH



DISSERTATION



ANTICIPATED TO TAKE
4-5 YEARS FULL-TIME

Coursework

54 credit hours of graduate coursework beyond a master's degree:

| | |
|--------------------------------|----|
| Advanced Statistics | 9 |
| COMD Advanced Research Methods | 3 |
| Grant Writing | 3 |
| Teaching Methods | 3 |
| COMD Proseminar | 3 |
| Special Topics in COMD | 9 |
| Electives | 6 |
| COMD Research | 6 |
| Dissertation | 12 |

Application

- **Fall Admission Only: December 15** (check website for updates)
- **Requirements:**
 - Commitment from COMD faculty member to mentor student
 - Official transcripts
 - Three (3) letters of recommendation
 - Curriculum vitae or resume
 - Statement of interest
- GRE scores are neither required nor taken into consideration during our admissions process.

Application

Addition Requirements for International Students:

- Demonstrate English Proficiency
- Letter of financial backing

<https://www.uh.edu/graduate-school/international-students/>

Funding

(availability varies from year to year)

Graduate Tuition
Fellowship (GTF)
9 credit hours per semester

Graduate
Assistantships
Research assistant, teaching
assistant or clinical assistant

Scholarships

Faculty

- Aphasia and right-hemisphere disorders
- Augmentative and alternative communication
- Bilingualism
- Dysphagia
- Language and phonological development
- Neural bases of speech and language
- Voice disorders



Contact

More about the program and how to apply

uh.edu/class/comd/programs/phd/

Dr. Ashwini Joshi, Program Director

ajoshi5@central.uh.edu

Paula Niño Kehr, Program Manager

pninokehr@uh.edu