

END OF THE SEMESTER SCHEDULES

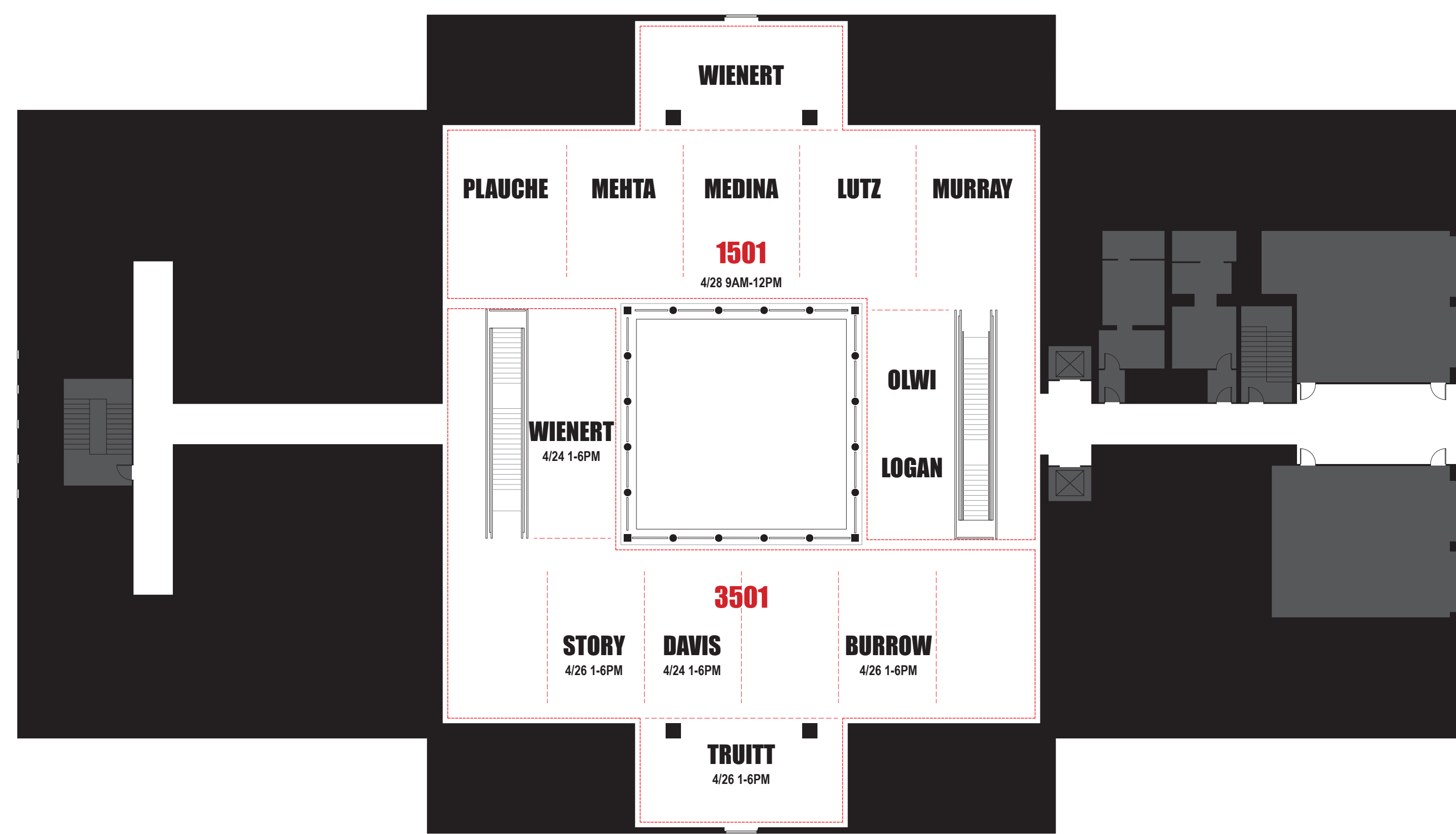

L4

APRIL	NORTH	SOUTH
24		1-6PM 3501 / DAVIS / WIENERT
25		
26		1-6PM 3501 / BURROW / STORY / TRUITT
27		
28	9-12PM 1501 / LOGAN / LUTZ / MEDINA / MEHTA / MURRAY / OLWI / WIENERT	

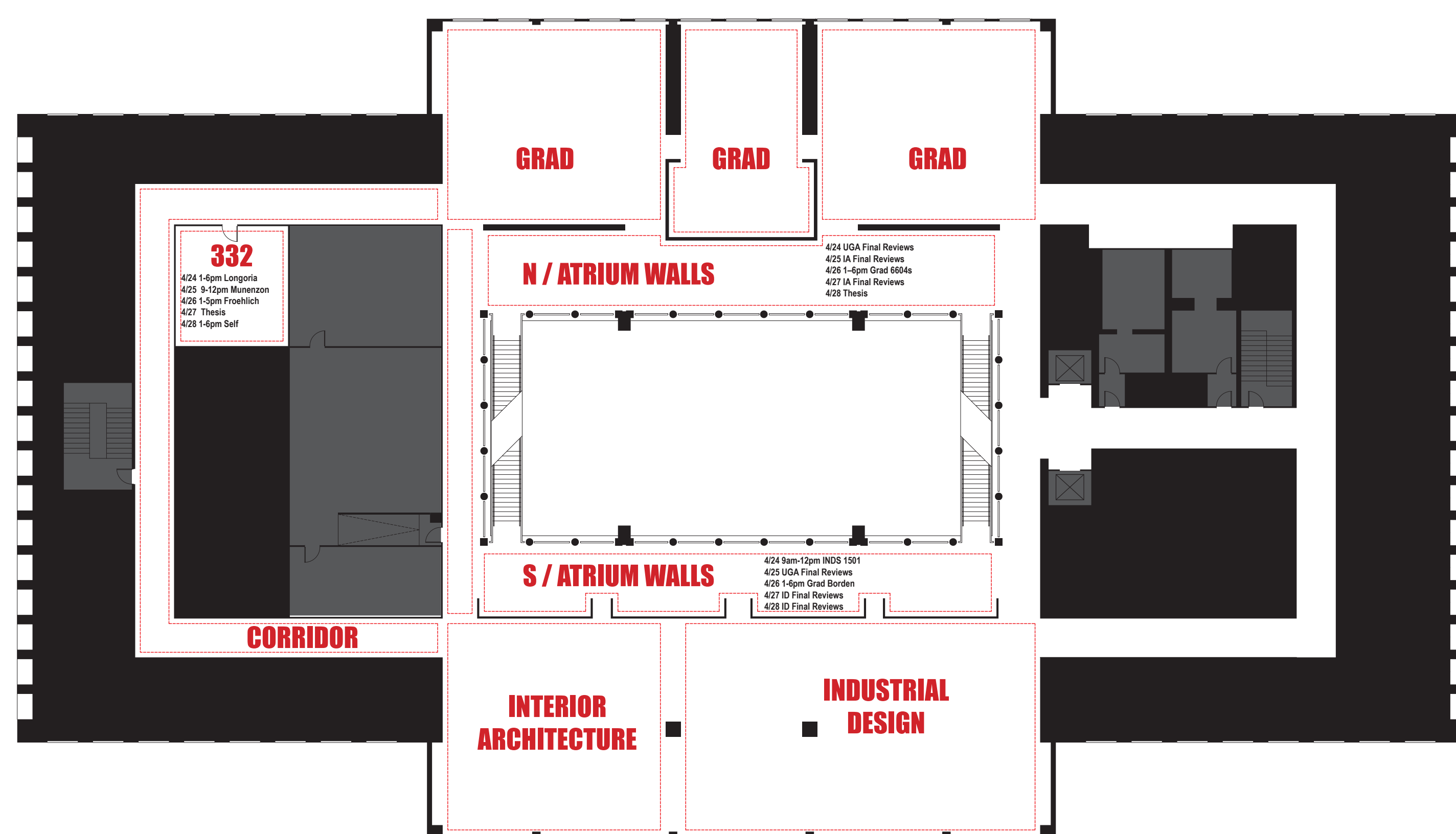

L3

APRIL	N / ATRIUM WALLS	S / ATRIUM WALLS	332	CORRIDOR
24	UGA FINAL REVIEWS	9AM-12PM INDS 1501	1-6PM GRAD LONGORIA	
25	IA FINAL REVIEWS	UGA FINAL REVIEWS	9-12PM MUNENZON	
26	1-6PM GRAD 6604S	1-6PM GRAD BORDEN	1-5PM GRAD FROEHLICH	
27	IA FINAL REVIEWS	ID FINAL REVIEWS	THESIS	
28	THESIS	ID FINAL REVIEWS	1-6PM 3501 SELF	

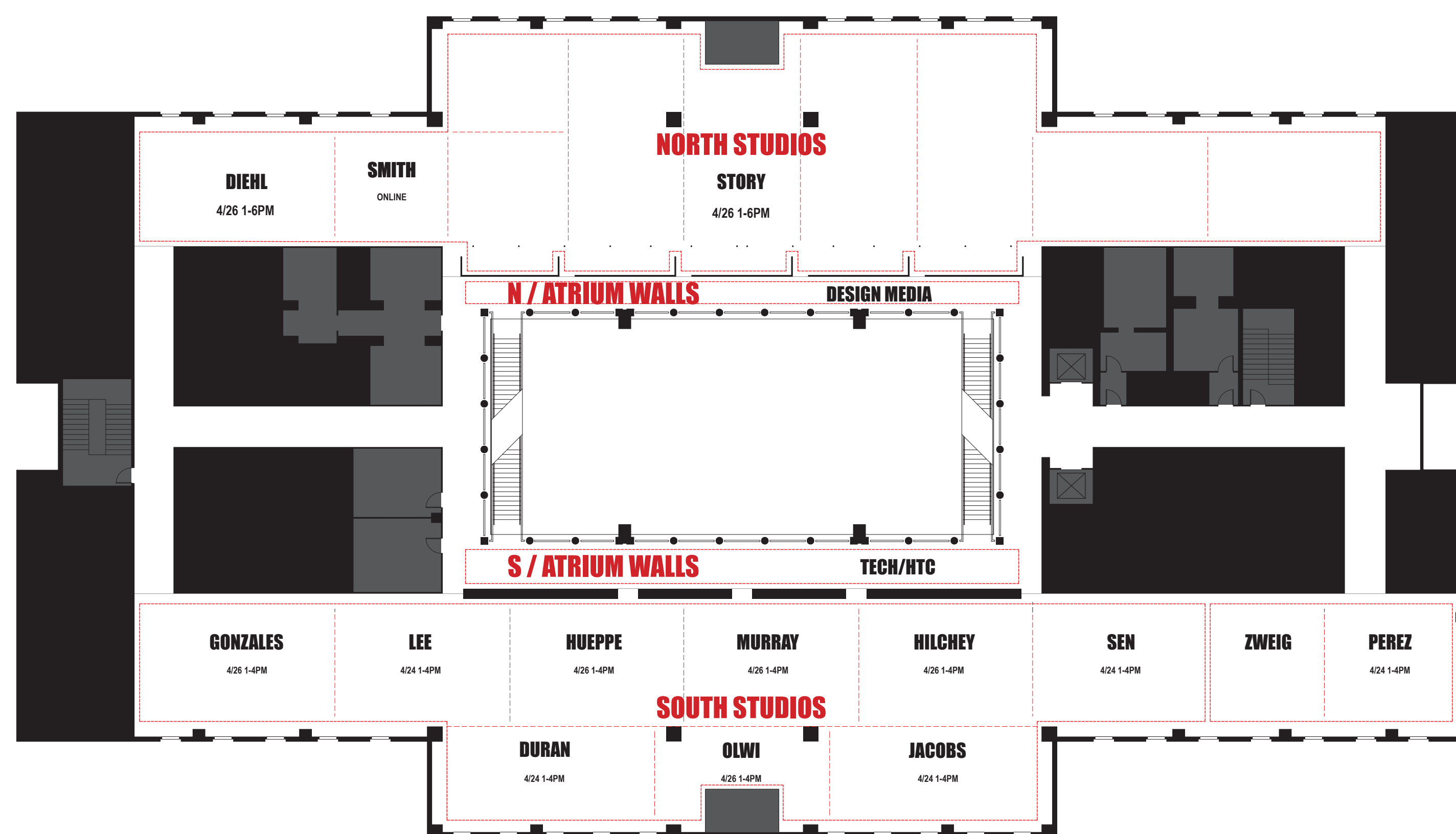

L2

APRIL	N / ATRIUM WALLS	S / ATRIUM WALLS	NORTH STUDIOS	SOUTH STUDIOS
24	UGA DESIGN MEDIA	UGA TECH/HTC	UGA 5500	1-4PM 5500 PEREZ / DURAN / JACOBS / HUEPPE / LEE / SEN
25	UGA DESIGN MEDIA	UGA TECH/HTC	UGA 5500	
26	UGA DESIGN MEDIA	UGA TECH/HTC	1-6PM 5500 DIEHL / STORY	1-4PM MURRAY / HILCHEY / GONZALES / OLWI
27	UGA DESIGN MEDIA	UGA TECH/HTC	UGA 5500	
28	UGA DESIGN MEDIA	UGA TECH/HTC	UGA 5500	



L1

APRIL	ATRIUM	MASHBURN	CDRC	143
24	1 1-6PM 5500 LUTZ 2 1-6PM 5500 PONCE 3 1-6PM 5500 ROLDAN / CARRAL	GRADUATING STUDENT EXHIBIT	12-6PM ROGERS	1-6PM 3501 KACMAR
25	1 UGA FINAL REVIEWS 2 UGA FINAL REVIEWS 3 UGA FINAL REVIEWS	GRADUATING STUDENT EXHIBIT	9-12 ID ELHAM	1-5PM UGA FINAL REVIEWS
26	1 1-6PM 5500 MCINTOSH/LOUIE 2 UGA FINAL REVIEWS 3 1-6PM 3501 / RIVERS	GRADUATING STUDENT EXHIBIT	UGA FINAL REVIEWS UGA	1-5PM BRUCE RACE
27	1 UGA FINAL REVIEWS 2 UGA FINAL REVIEWS 3 UGA FINAL REVIEWS	GRADUATING STUDENT EXHIBIT	FINAL REVIEWS UGA FINAL	2-4:30PM 1360 WILLIAMS
28	1 UGA FINAL REVIEWS 2 UGA FINAL REVIEWS 3 UGA FINAL REVIEWS	GRADUATING STUDENT EXHIBIT	REVIEWS	UGA FINAL REVIEWS

END OF THE SEMESTER SCHEDULES

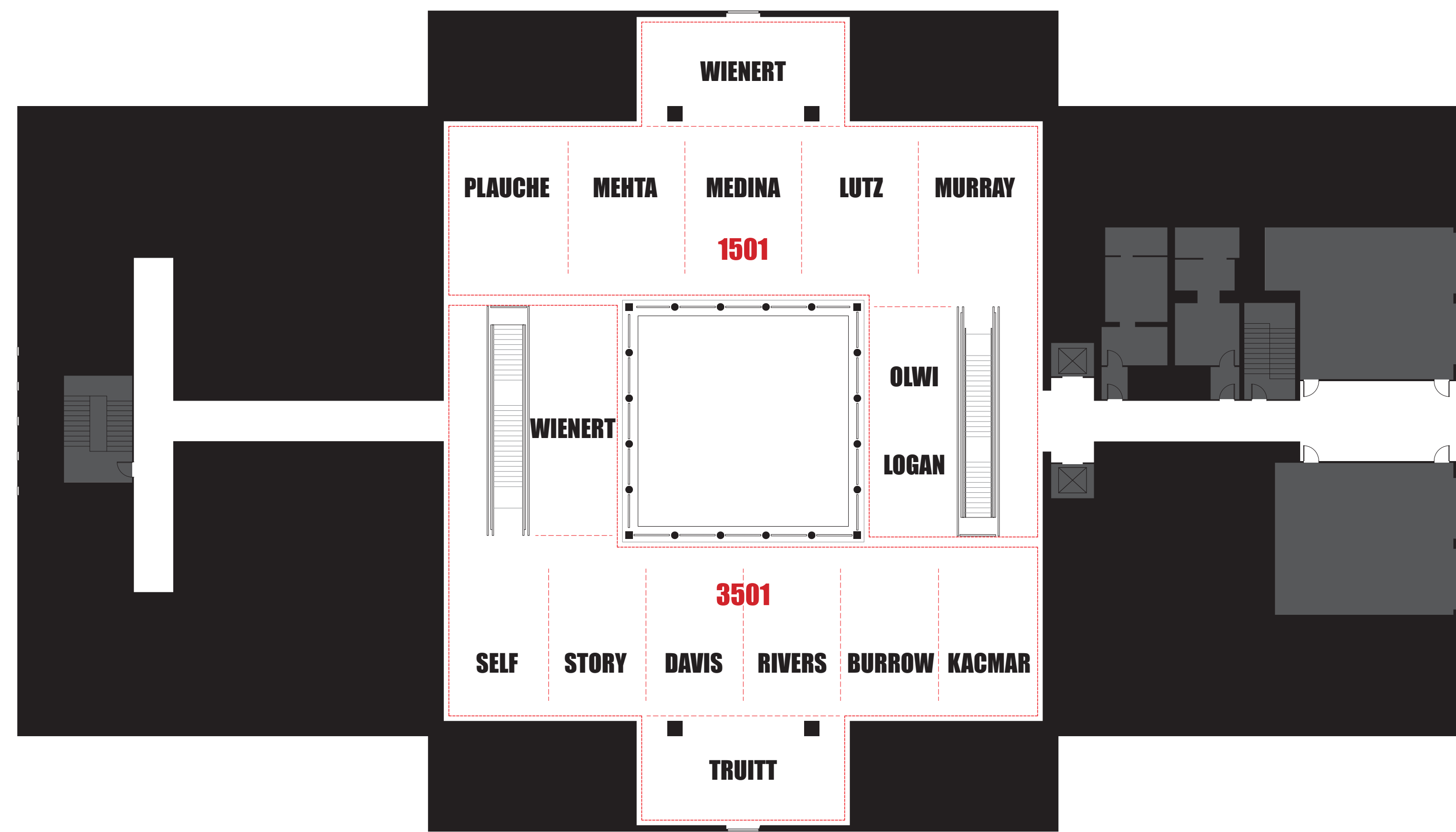

L4

		NORTH	SOUTH
APRIL	29	UGA 1501	UGA 3501
	30	UGA 1501	UGA 3501
MAY	01	UGA 1501	UGA 3501
	02	UGA 1501	UGA 3501
	03	UGA 1501	UGA 3501
	04	UGA 1501	UGA 3501
	05	UGA 1501	UGA 3501
	06	UGA 1501	UGA 3501
	07	UGA 1501	UGA 3501
	08	UGA 1501	UGA 3501
	09	UGA 1501	UGA 3501
10	UGA 1501	UGA 3501	
11	UGA 1501	UGA 3501	

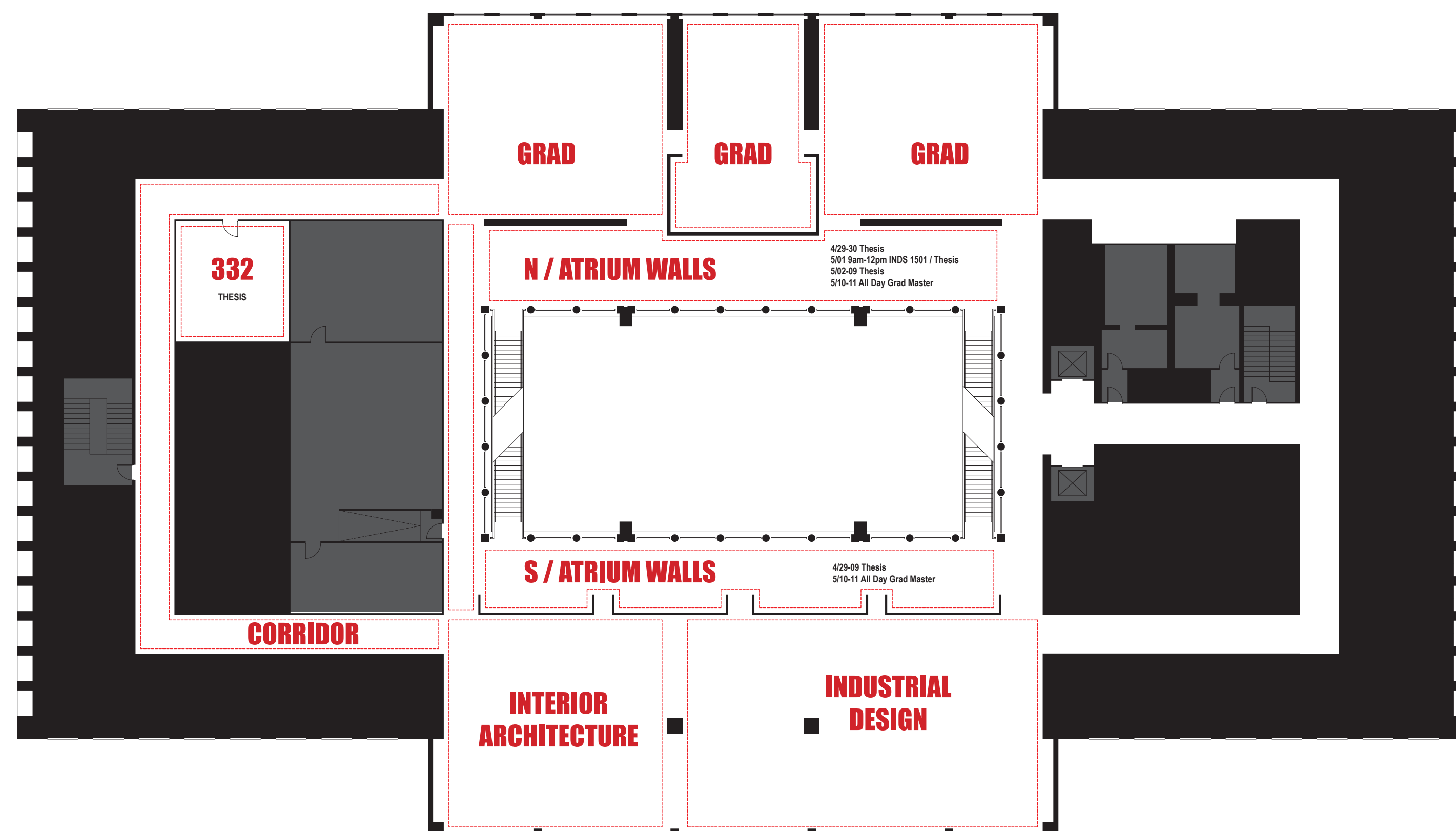

L3

		N / ATRIUM WALLS	S / ATRIUM WALLS	332	CORRIDOR
APRIL	29	THESIS		THESIS	
	30	THESIS		THESIS	
MAY	01	THESIS	9AM-12PM INDS 1501 / THESIS	THESIS	
	02	THESIS	THESIS	THESIS	
	03	THESIS	THESIS	THESIS	
	04	THESIS	THESIS	THESIS	
	05	THESIS	THESIS	THESIS	
	06	THESIS	THESIS	THESIS	
	07	THESIS	THESIS	THESIS	
	08	THESIS	THESIS	THESIS	
	09	THESIS	THESIS	UGA-COORD	
	10	ALL DAY GRAD MASTER	ALL DAY GRAD MASTER	THESIS	
	11	ALL DAY GRAD MASTER	ALL DAY GRAD MASTER	THESIS	

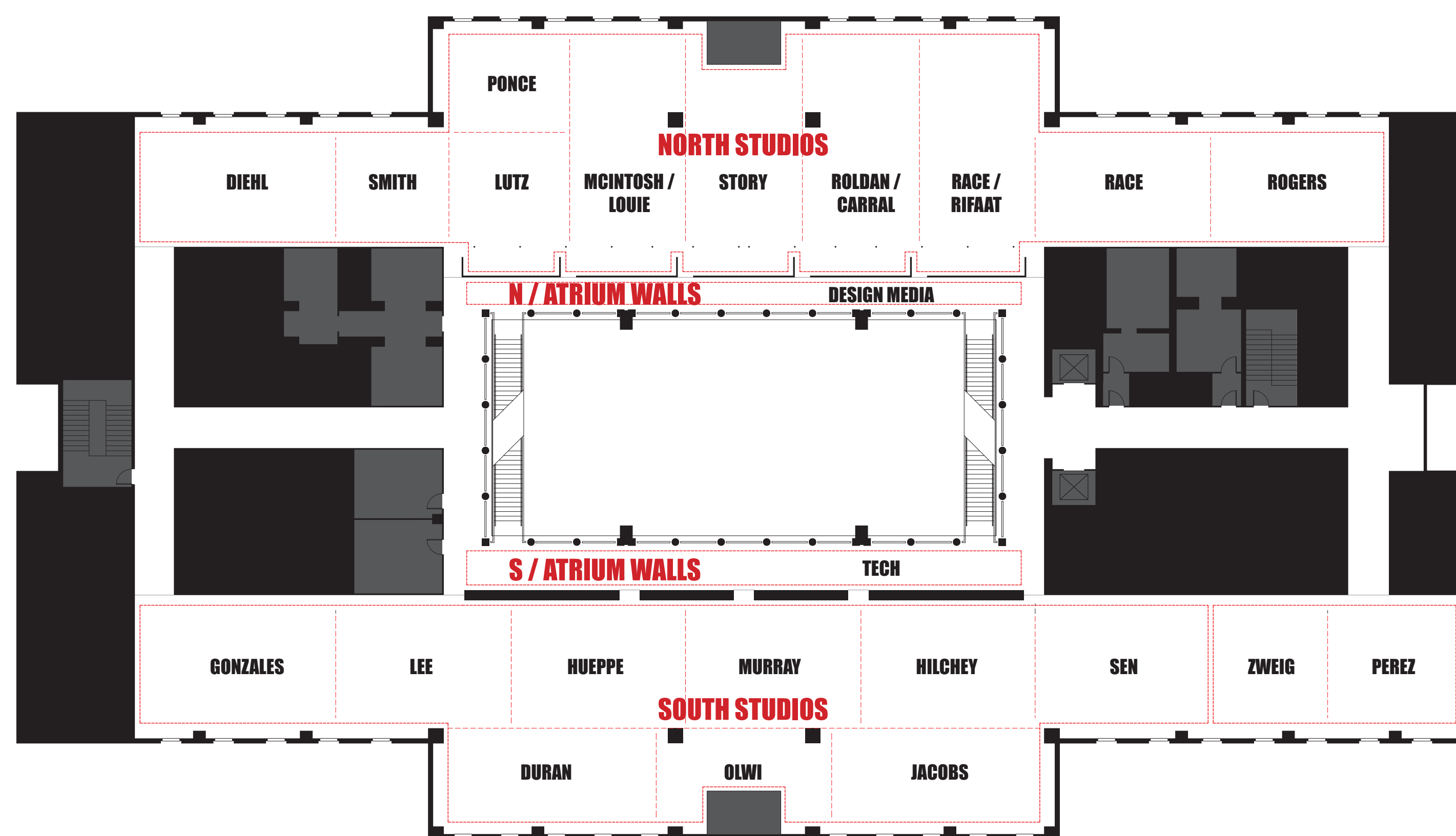

L2

		N / ATRIUM WALLS	S / ATRIUM WALLS	NORTH STUDIOS	SOUTH STUDIOS
APRIL	29	UGA TECH	UGA DESIGN MEDIA	UGA 5500	UGA 2501 / UGA 5500
	30	UGA TECH	UGA DESIGN MEDIA	UGA 5500	UGA 2501 / UGA 5500
MAY	01	UGA TECH	UGA DESIGN MEDIA	UGA 5500	UGA 2501 / UGA 5500
	02	UGA TECH	UGA DESIGN MEDIA	UGA 5500	UGA 2501 / UGA 5500
	03	UGA TECH	UGA DESIGN MEDIA	UGA 5500	UGA 2501 / UGA 5500
	04	UGA TECH	UGA DESIGN MEDIA	UGA 5500	UGA 2501 / UGA 5500
	05	UGA TECH	UGA DESIGN MEDIA	UGA 5500	UGA 2501 / UGA 5500
	06	UGA TECH	UGA DESIGN MEDIA	UGA 5500	UGA 2501 / UGA 5500
	07	UGA TECH	UGA DESIGN MEDIA	UGA 5500	UGA 2501 / UGA 5500
	08	UGA TECH	UGA DESIGN MEDIA	UGA 5500	UGA 2501 / UGA 5500
	09	UGA TECH	UGA DESIGN MEDIA	UGA 5500	UGA 2501 / UGA 5500
	10	UGA TECH	UGA DESIGN MEDIA	UGA 5500	UGA 2501 / UGA 5500
11	UGA TECH	UGA DESIGN MEDIA	UGA 5500	UGA 2501 / UGA 5500	

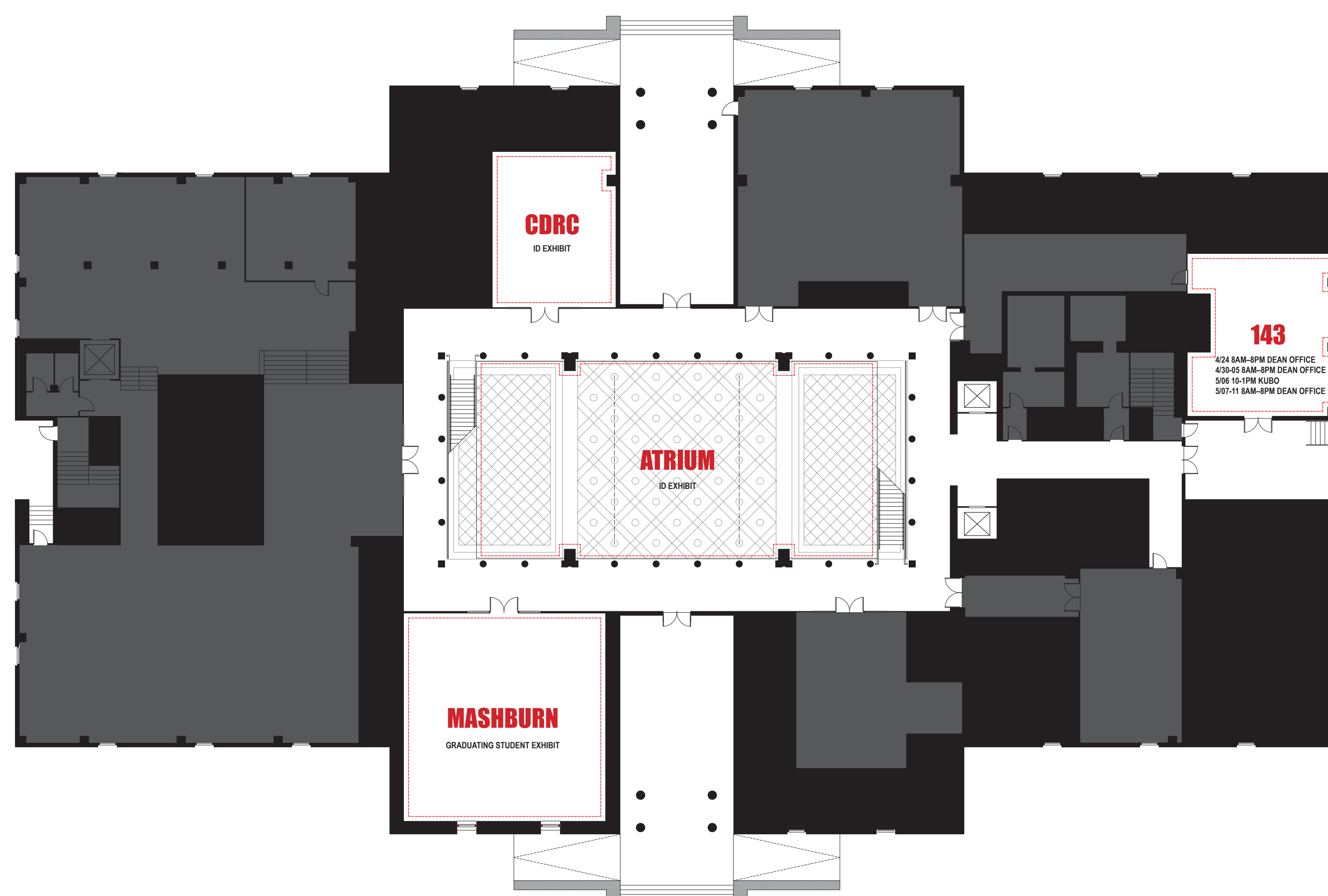

L1

		ATRIUM	MASHBURN	CDRC	143
APRIL	29		GRADUATING STUDENTS EXHIBIT		1-6PM 5500 ROLDAN /
	30		GRADUATING STUDENTS EXHIBIT		CARRAL 8 AM - 8 PM DEAN'S
MAY	01	ID EXHIBIT	GRADUATING STUDENTS EXHIBIT	ID EXHIBIT	OFFICE 8 AM - 8 PM DEAN'S
	02	ID EXHIBIT	GRADUATING STUDENTS EXHIBIT	ID EXHIBIT	OFFICE 8 AM - 8 PM DEAN'S
	03	ID EXHIBIT	GRADUATING STUDENTS EXHIBIT	ID EXHIBIT	OFFICE 8 AM - 8 PM DEAN'S
	04	ID EXHIBIT	GRADUATING STUDENTS EXHIBIT	ID EXHIBIT	OFFICE 8 AM - 8 PM DEAN'S
	05	ID EXHIBIT	GRADUATING STUDENTS EXHIBIT	ID EXHIBIT	OFFICE 8 AM - 8 PM DEAN'S
	06	GRADUATION	GRADUATING STUDENTS EXHIBIT		OFFICE 8 AM - 8 PM DEAN'S
	07	GRADUATION	GRADUATING STUDENTS EXHIBIT		OFFICE 8AM - 8 PM DEAN'S
	08	GRADUATION	GRADUATING STUDENTS EXHIBIT		OFFICE 8AM - 8 PM DEAN'S
	09	GRADUATION	GRADUATING STUDENTS EXHIBIT		OFFICE 8AM - 8 PM DEAN'S
	10	GRADUATION	GRADUATING STUDENTS EXHIBIT		OFFICE 8AM - 8 PM DEAN'S
11	GRADUATION	GRADUATING STUDENTS EXHIBIT		OFFICE	

END OF THE SEMESTER SCHEDULES

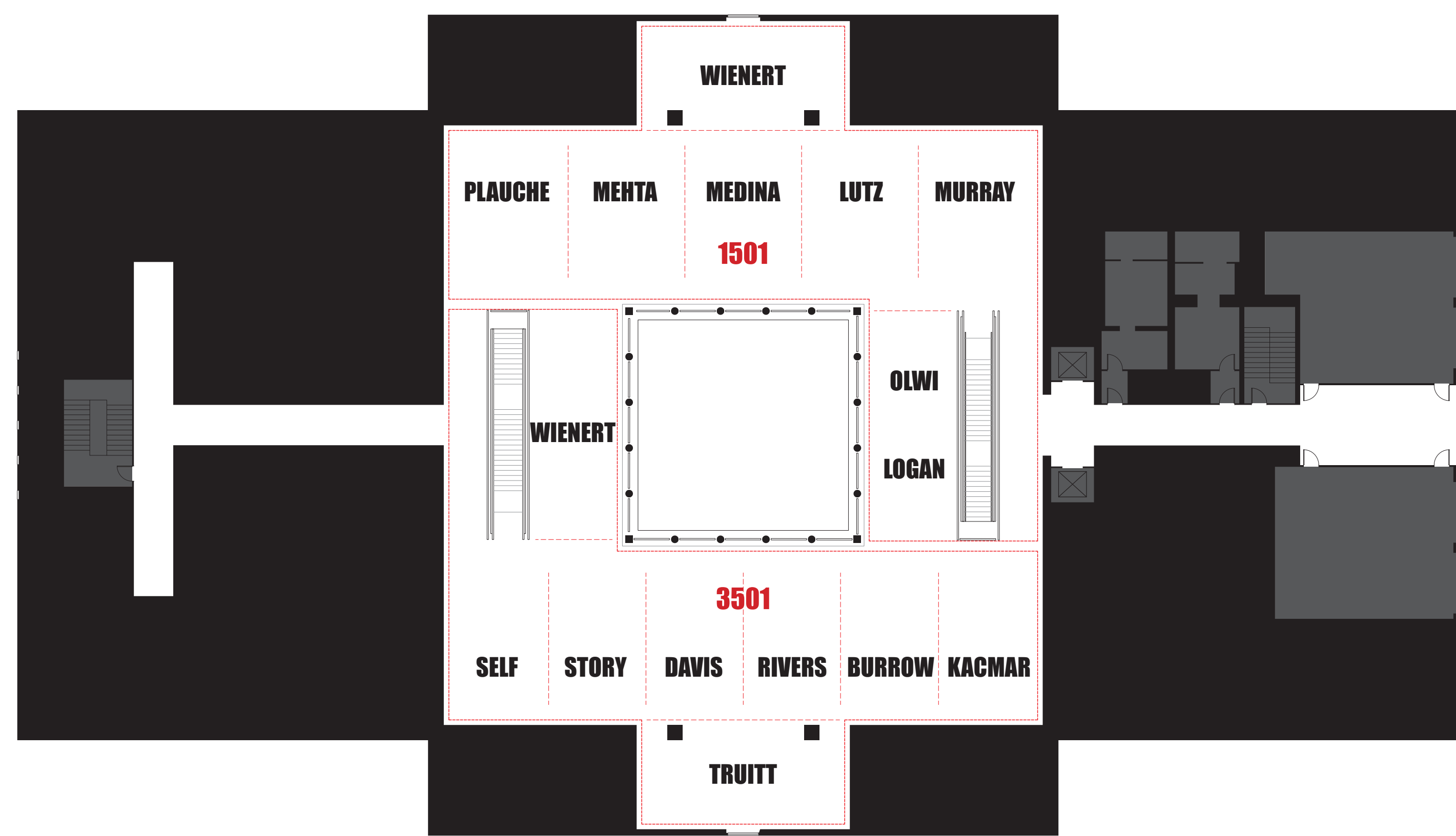

L4

		NORTH	SOUTH
MAY	12	UGA 1501	UGA 3501
	13	UGA 1501	UGA 3501
	14	UGA 1501	UGA 3501
	15	CLEAN UP	CLEAN UP

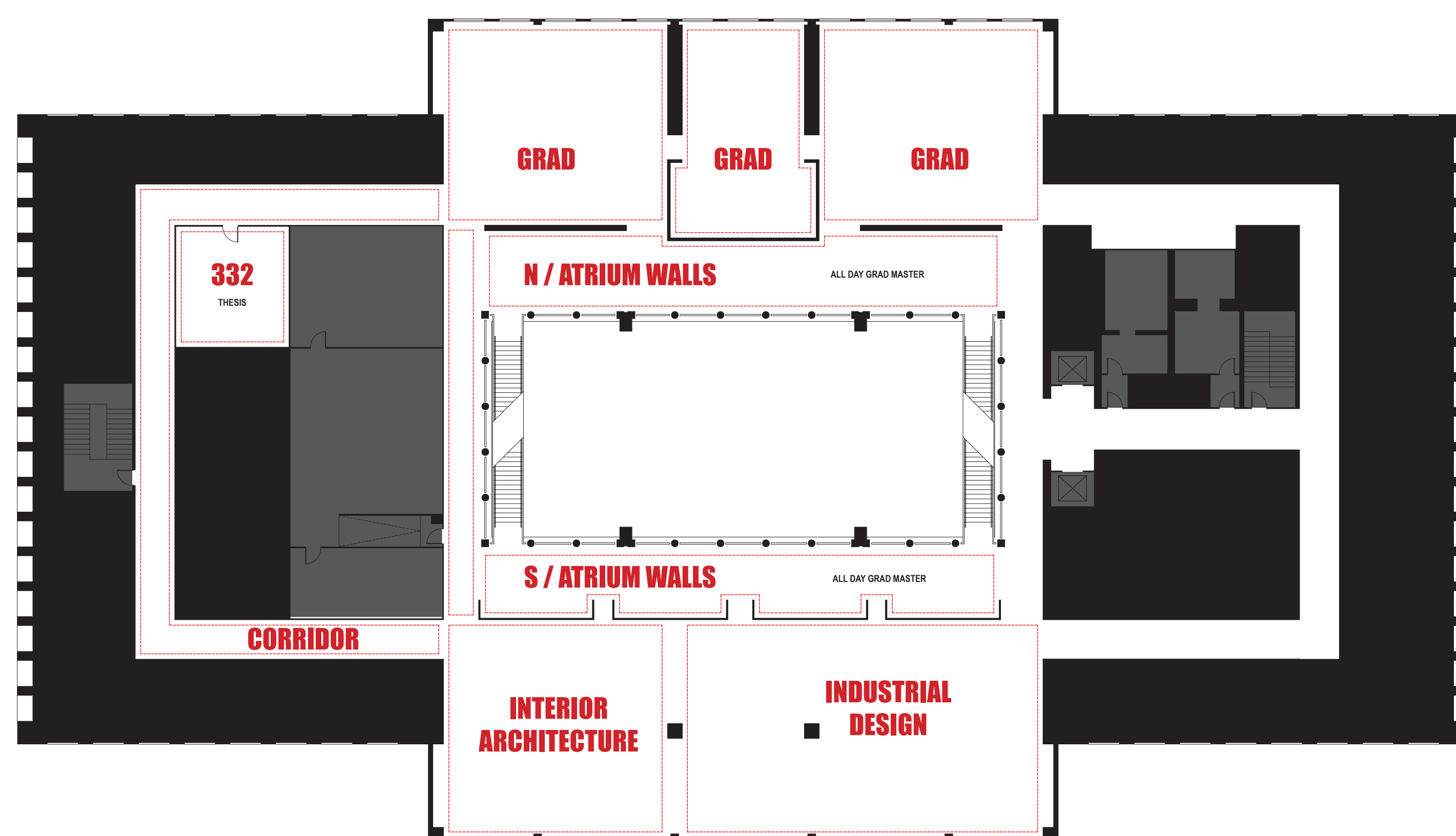

L3

		N / ATRIUM WALLS	S / ATRIUM WALLS	332	CORRIDOR
MAY	12	ALL DAY GRAD MASTER	ALL DAY GRAD MASTER	THESIS	
	13	ALL DAY GRAD MASTER	ALL DAY GRAD MASTER	THESIS	
	14	ALL DAY GRAD MASTER	ALL DAY GRAD MASTER	THESIS	
	15	CLEAN UP	CLEAN UP	CLEAN UP	

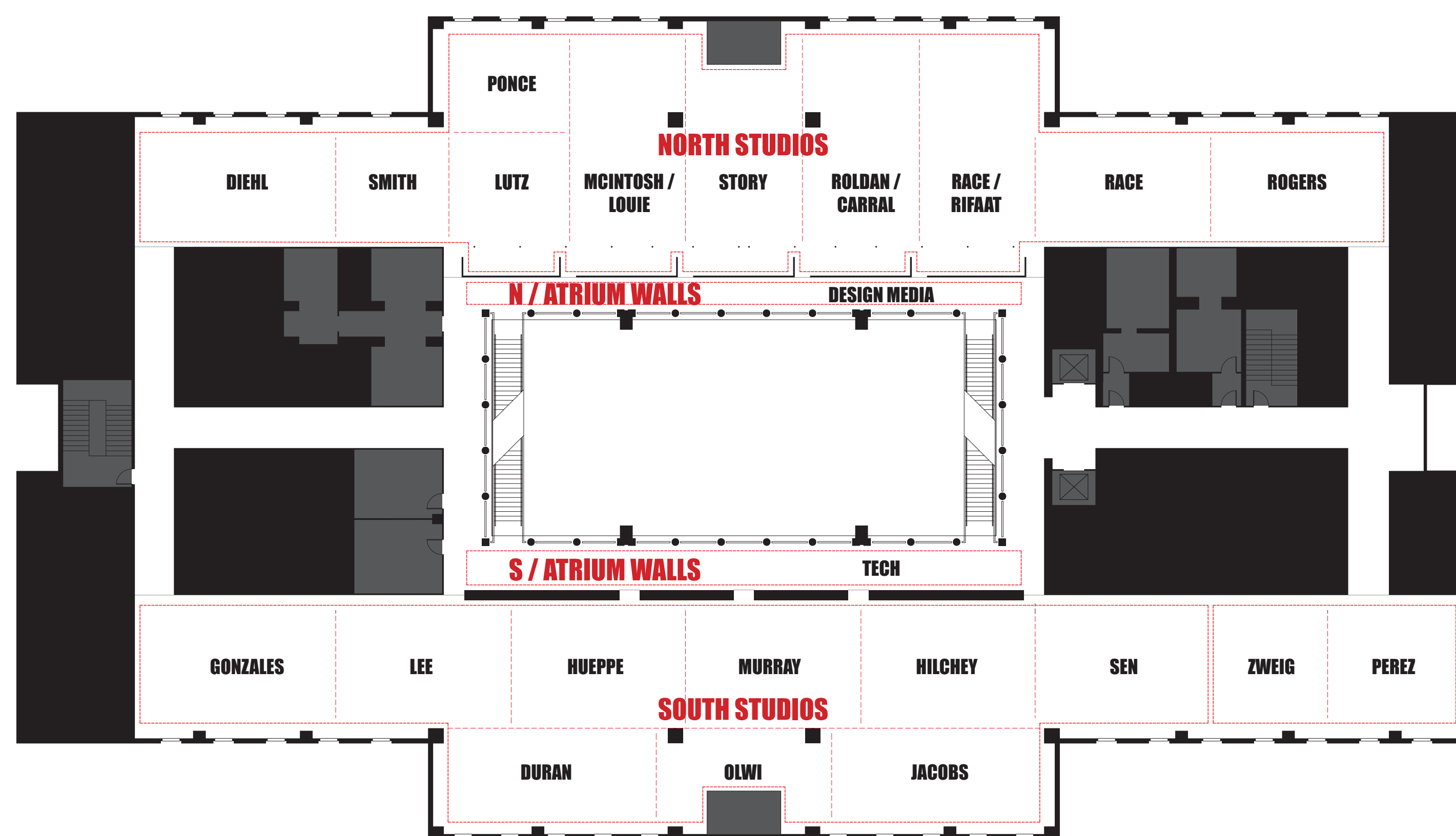

L2

		N / ATRIUM WALLS	S / ATRIUM WALLS	NORTH STUDIOS	SOUTH STUDIOS
MAY	12	UGA TECH	UGA DESIGN MEDIA	UGA 5500	UGA 2501 / UGA 5500
	13	UGA TECH	UGA DESIGN MEDIA	UGA 5500	UGA 2501 / UGA 5500
	14	UGA TECH	UGA DESIGN MEDIA	UGA 5500	UGA 2501 / UGA 5500
	15	CLEAN UP	CLEAN UP	CLEAN UP	CLEAN UP

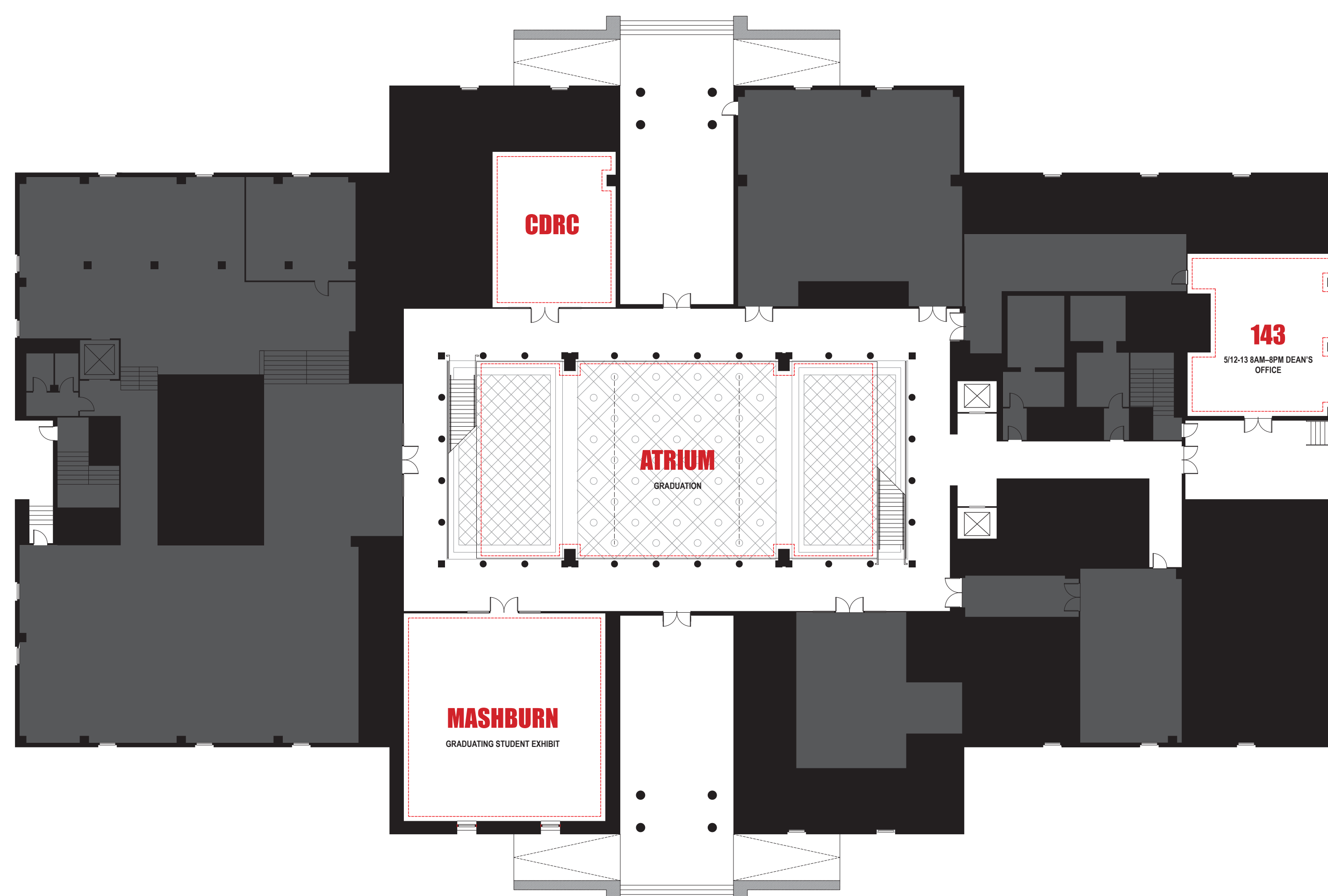

L1

		ATRIUM	MASHBURN	CDRC	143
MAY	12	GRADUATION	GRADUATING STUDENT EXHIBIT		8 AM – 8 PM DEAN'S OFFICE
	13	GRADUATION	GRADUATING STUDENT EXHIBIT		8 AM – 8 PM DEAN'S OFFICE
	14	GRADUATION	GRADUATING STUDENT EXHIBIT		
	15	CLEAN UP	CLEAN UP	CLEAN UP	CLEAN UP