

# Facilities Planning & Construction

September 13, 2018

# Facilities Planning & Construction



David Oliver

Associate Vice Chancellor/Associate Vice President

Facilities/Construction Management



Christa Rieck

Executive Director

University Architect

Facilities Planning & Space Management



Nicholas Merry

Executive Director

Project Management

## Planning at a Glance

- Space Management/Reporting
- University Architect
- In-house Engineering Team
- Interior Design Team (FF&E)
- Project Planning



## Space Management (UH Campus Only)

- Curator of current space allocations
- Curator of UH building floor plans
- THECB space reporting
- Developing “Campus Space Policies”

## University Architect

- Master Planning
- Master Specs & Guidelines
- Design Reviews
- Campus Sustainability



## Mechanical & Electrical Engineers

- Master Specs and Guidelines
- Design Reviews
- Site Inspections
- Trouble Shooting
- Optimization



## Interior Design Services

- Design Reviews
- Finish Standards (Guidelines & Master Specs)
- Space Standards
- Furniture Selections & Procurement

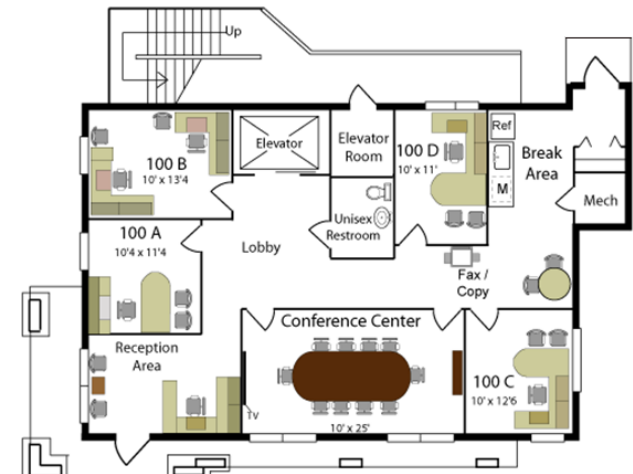

## Project Planning





## Work Request Arrival

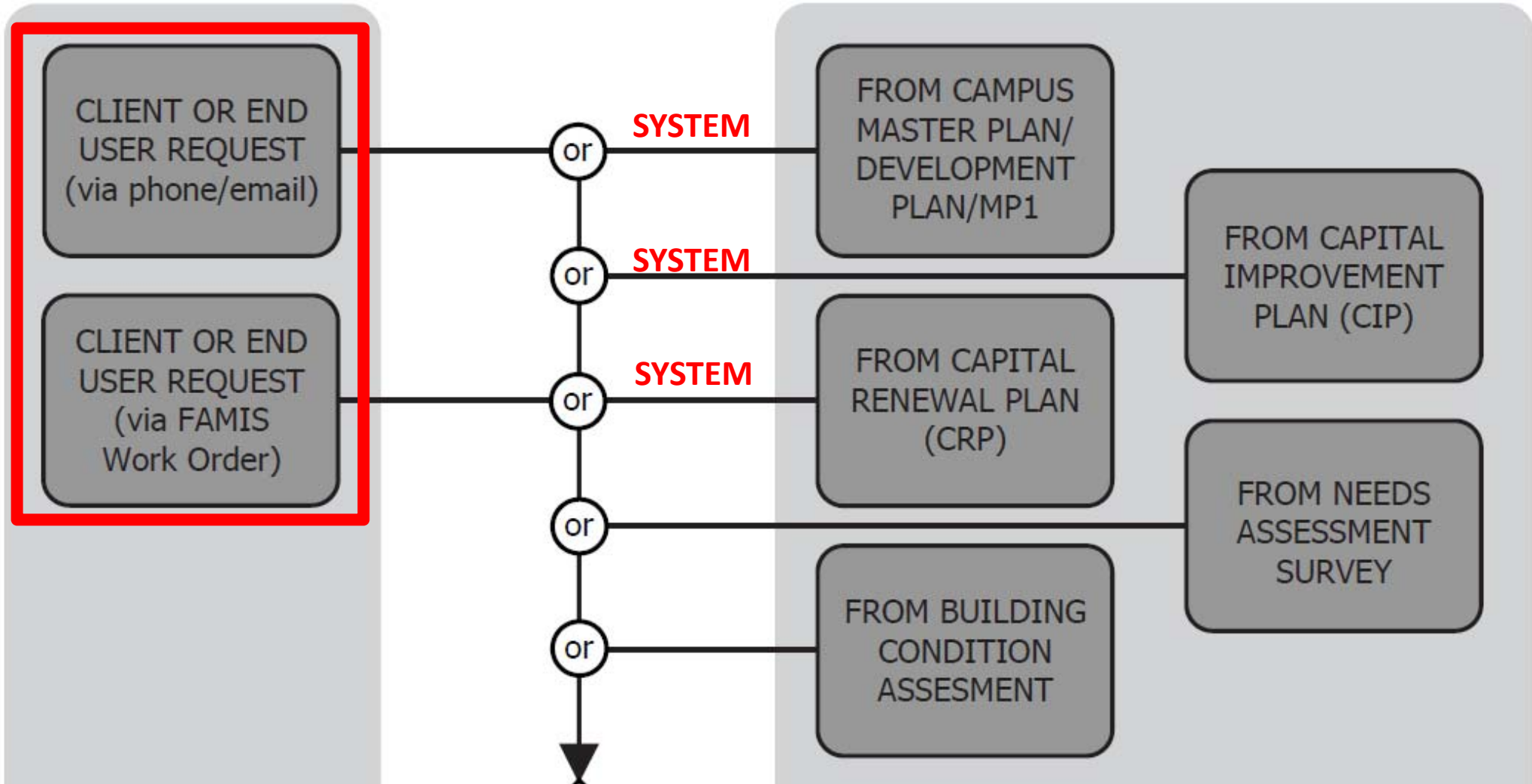

# Planning Overview

## Project Assignment

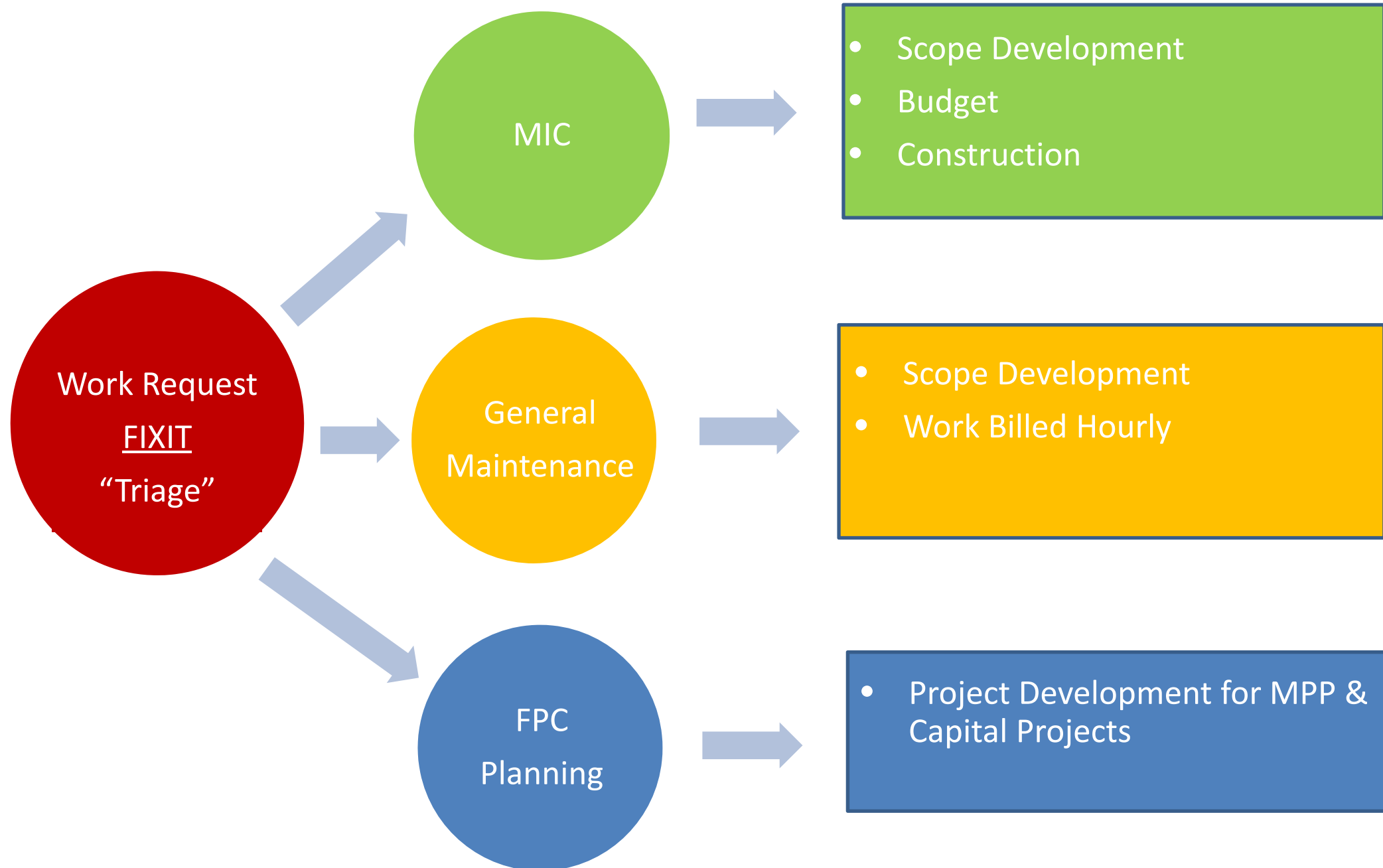

## Project Development

- Planner Assigned
  - Scope
  - PM Assignment (collaboration)
  - Budget (estimator)
  - Funding Approval & Transfer of Funds
  - Turned over to the Project Management Team

## Owner Representative for all Capital Projects

- Procurement
  - Collaborative with Purchasing
- Design
  - Collaborative with Customer, other departments  
(i.e. IT, Safety)
- Construction
  - Coordinated with Customer, other departments,  
external agencies

## Project Management Structure

- <\$1M – Minor Planned Projects Team
  - Design varies
  - JOC, CSP, In-house
- >\$1M – Project Management Team
  - Full design
  - CMAR, CSP
  - Sub Teams - \$1-\$10M; >\$10M; component campuses

# Future Project Overview

## Future Projects

- Core Projects
- Health 3
- Melcher Renovation
- Graduate College of Social Work
- Law Center



End

Questions