

# PhD in Communication Sciences & Disorders



Communication  
Sciences and Disorders  
College of Liberal Arts  
and Social Sciences

# About Houston

- Fourth largest city
- Access to a diverse population
- 45% speak a language other than English at home
- In 2021- 44% Hispanic, 24% White, 23% Black, 7% Asian, 2% other
- Close to 20 school districts
- World's largest medical center



# About UH



## UH AT A GLANCE

47,000+

*Students*

2,800+

*Faculty*

250

*Undergrad Majors @ Minors*

108

*Master's Degrees*

50

*Doctoral @ Professional Degrees*

37

*Research Centers*

# What to do with a PhD

## Research doctorate

- Academic position
  - Tenure track
    - Research emphasis
    - Teaching emphasis
  - Non-tenure track
    - Teaching emphasis
    - Clinical/Service position
- Clinical researcher
- Scientist



# About the Program

First cohort in Fall  
2020

Expanding  
program with  
more students and  
new faculty

Only program in  
the Greater  
Houston area

Individualized  
mentoring

Goal is to prepare  
researchers and  
scholars

Can be completed  
full-time or part-  
time

# Melcher Life Sciences

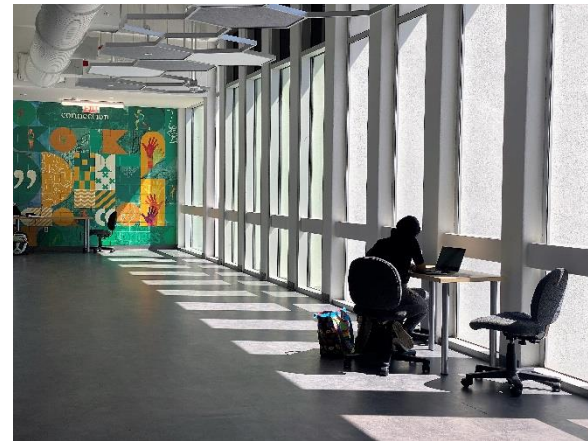
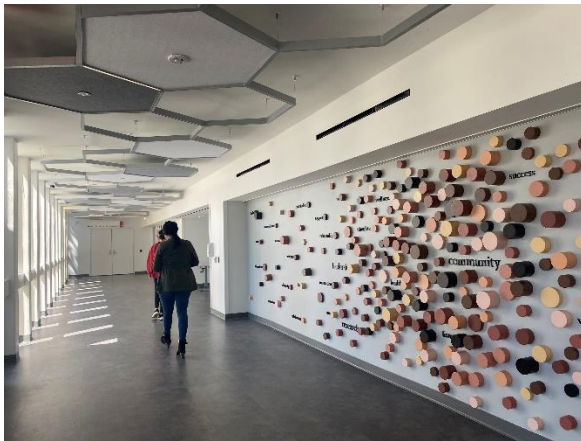

# Program Requirements



COURSEWORK



INITIAL RESEARCH  
PROJECT



COMPREHENSIVE  
EXAM



TEACHING  
EXPERIENCE



RESEARCH



DISSERTATION



ANTICIPATED TO TAKE  
4-5 YEARS FULL-TIME

# Coursework

54 credit hours of graduate coursework beyond a master's degree:

Advanced Statistics	9
COMD Advanced Research Methods	3
Grant Writing	3
Teaching Methods	3
COMD Proseminar	3
Special Topics in COMD	9
Electives	6
COMD Research	6
Dissertation	12



# Application

- **Fall 2023 Deadline: December 15, 2022**
- **Requirements:**
  - Commitment from COMD faculty member to mentor student
  - Official transcripts
  - Three (3) letters of recommendation
  - Curriculum vitae or resume
  - Statement of interest
- GRE scores are neither required nor taken into consideration during our admissions process.

# Application

## **Addition Requirements for International Students:**

- Demonstrate English Proficiency
- Letter of financial backing

<https://www.uh.edu/graduate-school/international-students/>

# Faculty



**Margaret Blake**  
Right hemisphere  
disorders



**Ferenc Bunta**  
Bilingual phonological  
acquisition



**Anny Castilla-Earls**  
Monolingual and bilingual  
language development



**Stephanie Daniels**  
Dysphagia



**Heather Dial**  
Neural bases of speech  
and language, Aphasia



**Ashwini Joshi**  
Voice disorders



**Lynn Maher**  
Aphasia



**Monique Mills**  
Narrative assessment  
and code-switching in  
bidialectal speakers

# Faculty



**Seoung Hoon Park**  
Neuroscience and  
neurorehabilitation



**Amber Thiessen**  
Augmentative and Alternative  
Communication (AAC)



**Camille Wynn**  
Speech coordination  
patterns of neurotypical  
and autistic adolescents

Visit [uh.edu/class/comd/research](https://uh.edu/class/comd/research)  
to learn more about our faculty

# Program Costs

## 22-23 Program Costs

- Tuition - \$2880 per semester
- Student Service Fee - \$260 per semester
- University Center Fee - \$135 per semester
- Recreation and Wellness Center Fee - \$112 per semester

## With Funding (GTF + TA Stipend)

- Tuition – **Free!**
- Earnings per semester, including cost of health insurance (\$6,000-\$10,000)

# Funding

*(availability varies from year to year)*

Graduate Tuition  
Fellowship (GTF)  
9 credit hours per semester

Graduate  
Assistantships  
Research assistant, teaching  
assistant or clinical assistant

Scholarships

# Contact

**More about the program and how to apply**

[uh.edu/class/comd/programs/phd/](http://uh.edu/class/comd/programs/phd/)

**Dr. Ashwini Joshi, Program Director**

[ajoshi5@central.uh.edu](mailto:ajoshi5@central.uh.edu)

**Paula Niño Kehr, Program Manager**

[pninokehr@uh.edu](mailto:pninokehr@uh.edu)

# Questions?

