

# **ARBOR BUILDING PUBLIC SCULPTURE PROPOSAL**

UNIVERSITY OF HOUSTON-CLEAR LAKE  
ARBOR BUILDING  
LOCATION BETWEEN THE NORTH AND CENTRAL ARBOR BUILDING

PREPARED BY **JASON MAKEPEACE**  
FEBURARY 2013

**To the Members of the University of Houston  
System Wide Art Acquisition Committee**

It was a unique opportunity to assist in the design and function of the new North Arbor building at the University of Houston-Clear Lake. An art professor rarely has the chance to help develop and help design a new facility in which to teach in. It is an honor for me to submit a proposal for public sculpture for the new and renovated site. I see this opportunity as a way to accentuate the BFA program at the UHCL campus. As a part of the university for the past eleven years teaching sculpture as well as being a MFA graduate from the University of Houston in 2002, I have a great appreciation to the University of Houston Clear Lake and the University of Houston. Thank you for taking the time to review my proposal.

## **Table of Contents**

Artist Statement	1
Sculpture Examples	2-3
Proposal/Sculpture Description	4
Location Description	5
Preliminary Foundation Design	5
Safety & Liability	6
Maintenance	6
Accessibility	6
Preliminary Budget	7
Sculpture Illustration	8
Schematic Layout & Location Choices	9-14
Preliminary Foundation Design	15
Résumé	16-21

## **Artist Statement**

### **“Moldable Subtractions”**

As an avid kayaker I find it interesting that the basic design of the canoe and kayak to stay afloat and carry people has not changed over thousands of years. What has changed is the process by which these kayaks are crafted. Being an artist who is very rooted in and respectful of craftsmanship, I find this juxtaposition intriguing and rich with history. This series of sculptures explore the relationship between new and old technology and how craftsmanship maintains itself even when the base materials change.

Modern kayaks are constructed through intricate molds with injected plastic, fiberglass, and even carbon fiber. This is a stark contrast from the first canoes, which were carved directly from large trees. I want to create work that reveals this contrast. The work references the sleek design of the modern day kayak and at the same time acknowledges and respects the history of the design. Each sculpture is carved out of a single log. The exposed carved sections of the wood represent the modern day kayak, while the unfinished natural logs represent the history of the kayak.

Evolution of design with the constant thread of craftsmanship maintains the growth of form.



## Sculpture Examples



## Sculpture Examples



## Proposal/Sculpture Description

My proposal consists of one vertical sculpture based on my current body of work. It will be located between the North and Central Arbor Building. This sculpture represents the idea of the finding something great from within. The historic dugout canoe that is made by carving it from one large tree will represent this concept, but with a modern twist. My interpretation will have a modern designed kayak exposed vertically from a large tree stump.

The kayak will be merging from a tree, yet to be fully revealed. The kayak will be constructed out of carbon steel and powder-coated a vibrant red. The symbolism behind this vibrant color design is two-fold. For one I wanted to reference the vibrant color palette modern kayak manufactures use today and I also wanted to express a harmonious color perspective. I wanted the piece to have both bold and balanced contrasts. I can visualize this sculpture catching the eye of students walking through the campus because of it's bold color and it's striking contrast against the building. I also believe the vibrant color of the sculpture will enhance the natural beauty of the campus through harmonious color schemes. Throughout the year the colors of the sculpture will create complementary and analogous color schemes with the campus's natural landscape.

The tree stump will be constructed of steel, metal lath, and colored concrete. The stump's color and texture will mimic the natural colors of the surrounding trees. There will be an anchoring foundation of rebar and concrete below ground level with exposed bolts for assembling the sculpture to the ground. An interior powder-coated steel support frame will be bolted to the foundation bolts. The kayak will then be bolted to the top of the support frame. The support frame will then be encased by a welded carbon steel armature mimicking the large tree stump. The armature will be faced with metal lath and finally covered and sculpted with colored concrete to finalize the appearance of a large tree stump growing up from the ground. All bolts, washers and nuts will be stainless steel (see page 8).

## Location Description

**Location 1** is located between the North and Central Arbor building. I have selected the natural area between the sidewalk and the southern side of the North arbor building. The illustration and dimensions of the sculpture can be seen in my sculpture illustration (see page 8). Location 1 is my first choice.

**Location 2** is located midway along the sidewalk in front of the North Arbor and Central Arbor building. It is between the sidewalk and University Drive. Location 2 is my second choice.

**Location 3** is an alternative design location. This design would change to a horizontal wall mounted sculpture. The sculpture would no longer be represented as to be merging from a tree and would be the skeletal framework of the kayak alone. The dimensions would be approximately 151" wide by 19.5" tall by 8" deep. Location 3 gives an interior option to my proposal and it is my third choice.

**Location 4** is located at the entrance drive to the North Arbor building along University Drive. It is between the North Arbor building's drive entrance and the bridge over the bayou along the sidewalk. Location 4 is my forth choice.

These 4 locations are illustrated through site maps and photographs of the North Arbor Building (see pages 8-14).

## Preliminary Foundation Design

The foundation design is for location 1, 2, & 4. The concrete will be reinforced with rebar. After discussing this project with Jan Mak, the Architect/Project Manager for UHCL, he felt the foundation design would be adequate for the project. He also feels the open frame design will help minimize any wind concerns. The foundation's final design might change if a civil engineer needs to review and certify it. The top of the foundation will be flush with ground level (see page15).

## **Safety & Liability**

I have one safety and liability issue with the piece. It's ability to with stand hurricane force winds. I feel this issue can be taken care of by a civil engineer, certifying the final overall design.

As a faculty member I feel it is important to broaden university students. I could see working collaboratively with the Civil Engineer Program at the University of Houston to engage more than just our art program students. As I plan to have UHCL's art students involved from start to finish with my project. The Civil Engineer program at University of Houston could use this opportunity with their classes. A class could discuss and work on the design of the kayak's anchoring foundation and it's support frame structure. They could discuss all civil codes dealing with this type of public sculpture. The Civil Engineer professor could possibly certify the sculpture to be ready for installation?

## **Maintenance**

Maintenance issues should be minimal since the materials for this piece will be powder-coated steel and colored concrete. An occasional washing with a low-pressured pressure washer should be sufficient for cleaning the sculpture. I will not be responsible for any cleaning and any repairs to the sculpture once installed. An art conservator or myself can be asked to enter a bid for such issues if they may arise.

## **Accessibility**

Public access for all differently abled people should not be a problem since the sites are in close proximity to the sidewalks leading to and around the North Arbor building. All sidewalks are wheelchair accessible.

## Preliminary Budget

### Project Cost Estimates:

Concrete for Foundation (qty. 21 80lbs. bags)	\$ 100
Spec Mix 80lbs. (qty. 15 bags)	\$ 90
NewLook Cement Colors	\$ 80
Concrete Binder (5 gallons)	\$ 150
Concrete Mixer Rental (24hrs.)	\$ 150
Auger Rental (24hrs.)	\$ 180
Nycon PVA RMS702 fiber (qty. 2 – 1lbs. bags) (s/h included)	\$ 40
3/8" Rebar (qty. 5 – 20' lengths) (s/h included)	\$ 25
1/4" Round Bar (qty. 10 – 20' lengths) (s/h included)	\$ 45
Miscellaneous hardware & tools	\$ 275
CNC Plasma Cut Steel and Rolled Steel	\$ 3725
Steel Lath (qty. 4 sheets)	\$ 35
Stainless Steel Bolts/Washers/Lock Washers/Nuts	\$ 250
All Welding Fabrication	\$ 11,423
Assistant (miscellaneous labor)	\$ 1000
Powder Coating	\$ 250
Travel for materials. Gas, wear, & tear (.60 per mile – 200 miles)	\$ 120
Civil Engineer	\$ ?

Any certifications could be completed in house through  
UH's Civil Engineer Program.

Retail Value of Sculpture:	\$ 10,000
----------------------------	-----------

Total Cost of the Project:	\$ 27,938
----------------------------	-----------



## Sculpture Illustration

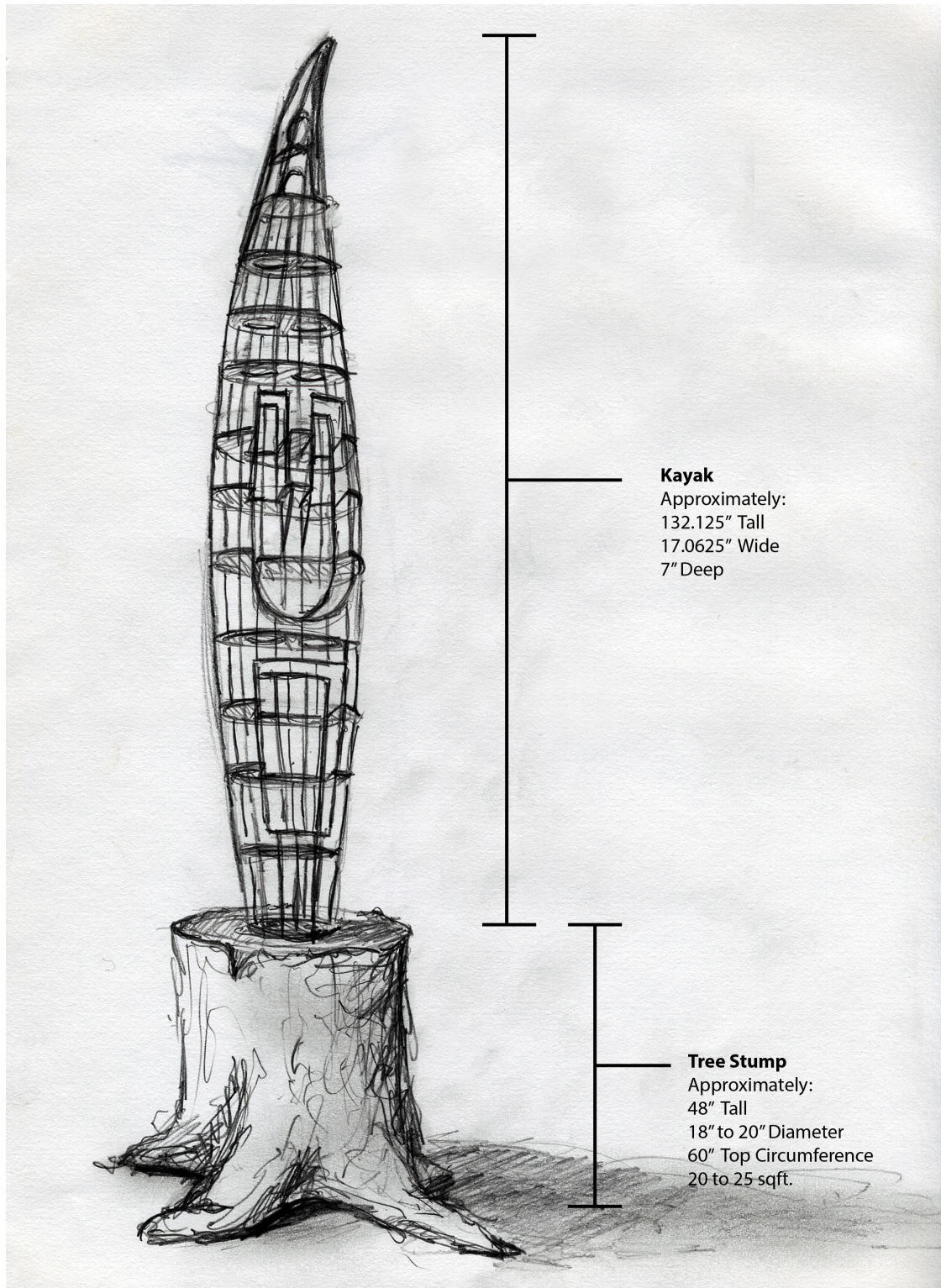

## Schematic Layout of North Arbor Building

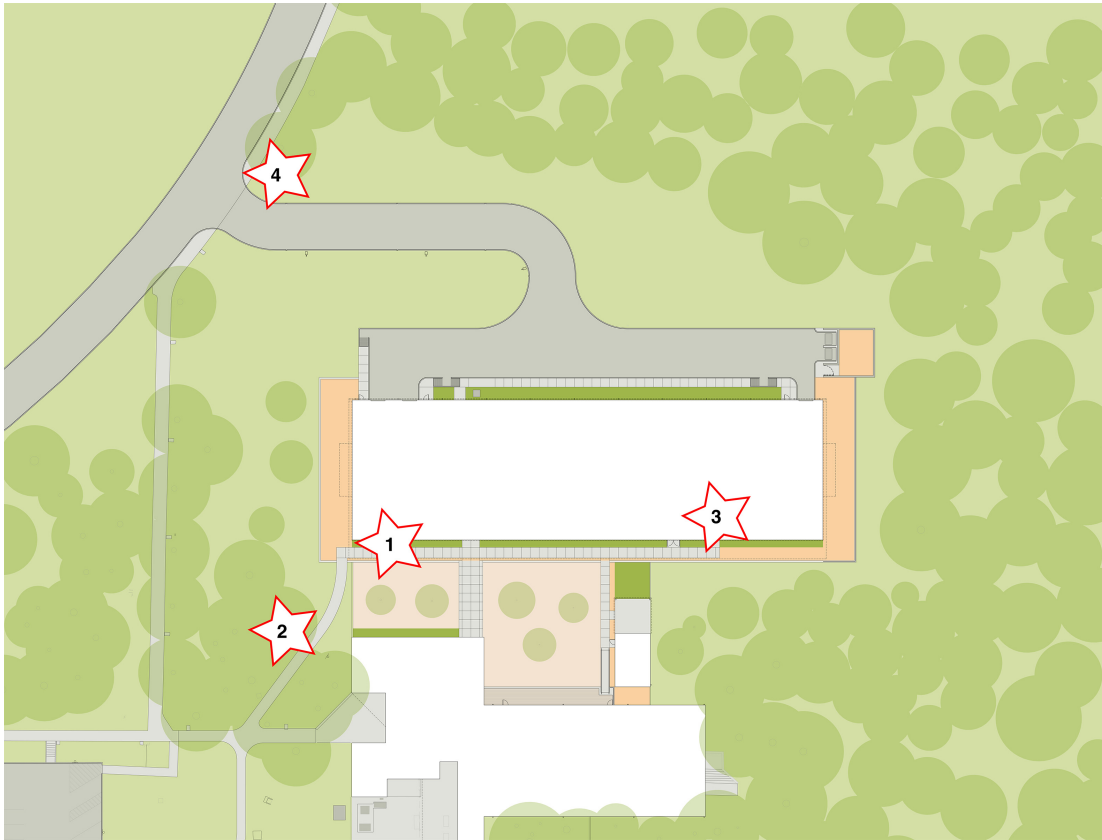

- Location 1. Primary Choice (Exterior)
- Location 2. Secondary Choice (Exterior)
- Location 3. Third Choice (Interior)
- Location 4. Forth Choice (Exterior)

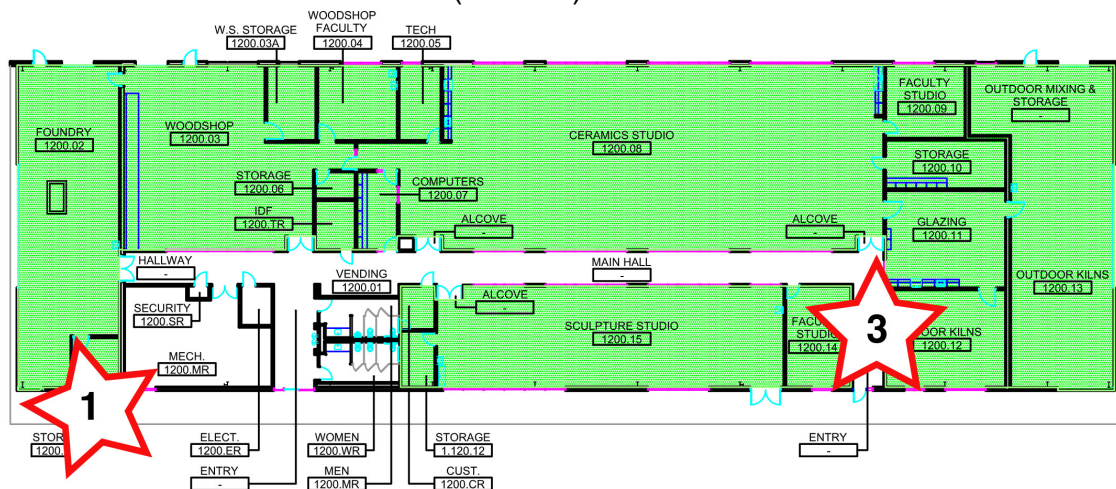

ARBOR NORTH DIRECTORY



## Location 1



1<sup>st</sup> Choice - Exterior

## Location 1



1<sup>st</sup> Choice – Exterior

## Location 2



2nd Choice – Exterior



### Location 3



3<sup>rd</sup> Choice – Interior

## Location 4



4<sup>th</sup> Choice – Exterior

## Preliminary Foundation Design

(Location 1) –Approx.: 12.1 Cubic Feet/.45 Cubic Yards

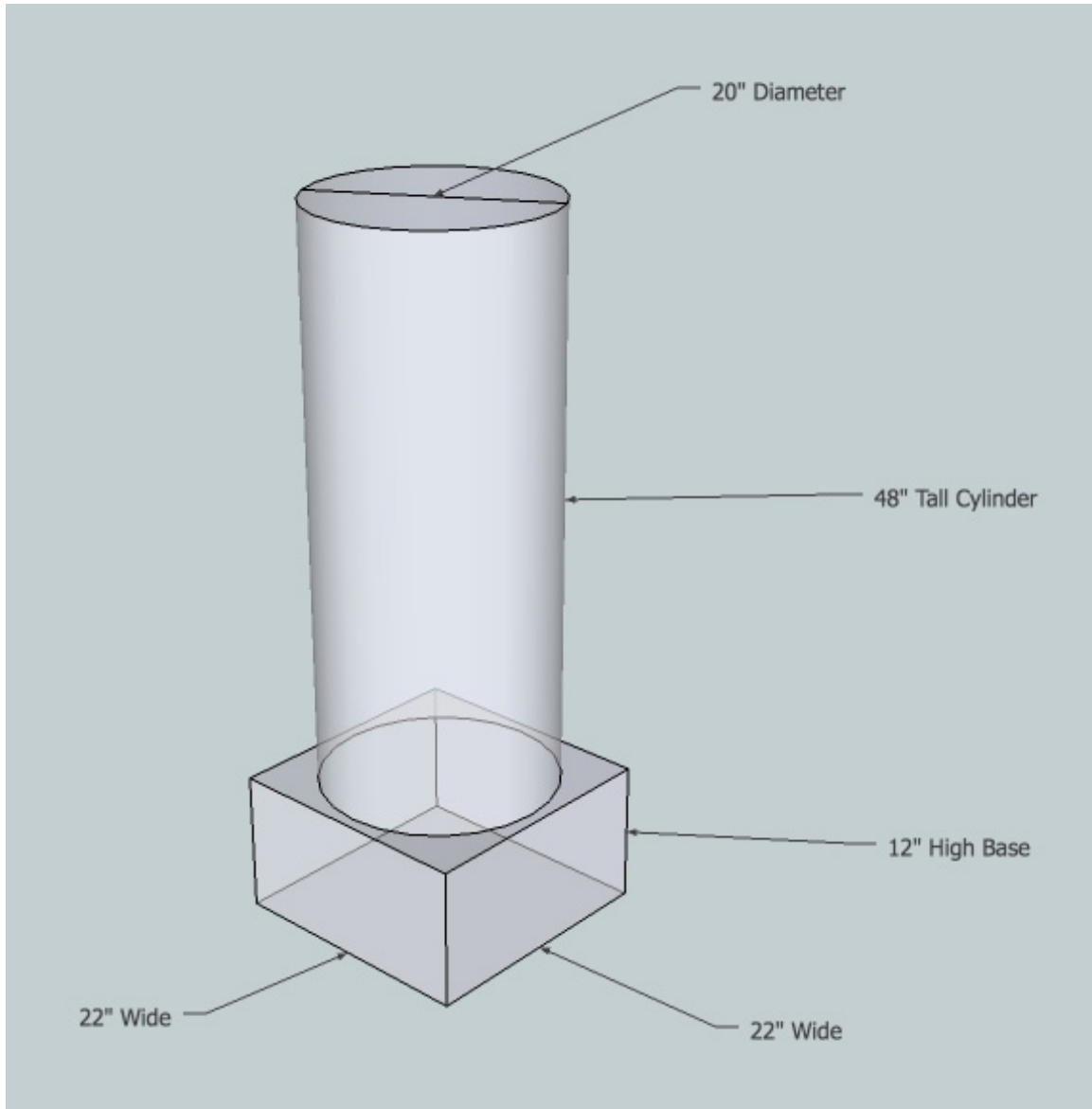

## Résumé

### Education

- 2002 Masters of Fine Arts, Sculpture, University of Houston, Houston, TX  
1997 Bachelor of Arts, Sculpture, College of Charleston, Charleston, SC  
University of Georgia, (Cortona, Italy, June-August 1997, Marble Carving  
/20<sup>th</sup> Century Italian Art History)

### Teaching Experience

- 2011-12 Senior Lecturer in Art and Design, Full-time Sculpture Professor, Univ. of  
Houston Clear Lake, Houston, TX  
2007-11 Continuing Lecturer in Visual Art, Full-time Sculpture Professor, University  
of Houston, Clear Lake, Houston, TX  
2005-07 Visiting Lecturer in Visual Art, Full-time Non-tenured Sculpture Professor,  
University of Houston, Clear Lake, Houston, TX  
2001-05 Adjunct Professor, Beginning & Advanced Sculpture & Special Topics,  
University of Houston, Clear Lake, Houston, TX  
2002-03 Sculpture Consultant HSPVA (High School for Performance and Visual  
Arts), Houston, TX  
2002 Assistant Instructor, International Sculpture Conference's Foundry  
Workshop, Houston, TX  
2001 Adjunct Professor, Fundamentals of Sculpture (summer semester),  
University of Houston, Houston, TX  
2000 Teaching Fellow, Fundamentals of Sculpture (fall semester), University of  
Houston, Houston, TX

### Awards

- 2011 24<sup>th</sup> Annual Houston Artcar Parade, 1<sup>st</sup> Place Artcar Grand Trophy for "ouR  
MUTT 2011"  
2009-10 Minnie Stevens Piper Award Finalist, Univ. of Houston Clear Lake  
2004 The Arch and Anne Giles Kimbrough Fund, Dallas Museum of Art Grant,  
Dallas, TX  
2003 Individual Artist Grant, CACHH (Cultural arts Council of Houston & Harris  
County)  
2001-02 Minnie Stevens Piper Award Finalist, Univ. of Houston Clear Lake  
The Dedalus Foundation Masters of Fine Arts Fellowship Nominee  
2000 Outstanding Student Achievement in Contemporary Sculpture Award,  
International Sculpture Center, Hamilton, NJ  
Opening Moves Scholarship, University of Houston  
1999 Friends of Art Graduate Scholarship, University of Houston  
1997 Janet Simcox Scholarship, College of Charleston

## Solo Exhibitions

- 2011 *Moldable Subtractions*, Lonestar College, Conroe, TX  
2005 *Reconditioned*, Lawndale Art Center, Houston, TX  
2004 *...it's a wonderful toy...*, Poissant Gallery, Houston, TX  
2003 *New Works, Recent drawings and sculptures*, Galveston Art Center, Galveston, TX  
1998 *Domesticated*, Solo Exhibition, Simons Gallery, Charleston, SC

## Selected Group Exhibitions

- 2011 *Insperity Golf Experience*, Discovery Green, Curated by Clint Wilhour, Houston, TX  
24<sup>th</sup> Annual Houston Artar Parade, Orange Show, Houston, TX  
*UHCL Faculty Art Exhibition*, UHCL, Houston, TX  
*Mentor Exhibition*, TAACCL, Juried exhibition, Clear Lake, Texas  
*Summer Open Show*, TAACCL, Juried exhibition, Clear Lake, Texas  
2010 *Jason & Nina Makepeace Exhibition*, Poissant Gallery, Houston, TX  
*Winter Open Show*, TAACCL, Juried exhibition, Clear Lake, Texas  
2008 *UHCL Faculty Art Exhibition*, UHCL, Houston, TX  
2007 *Open Door Series, Winter '07*, TAACCL Juried exhibition, Clear Lake, Texas  
*Pushing the Envelope, A Drawing Show*, Williams Tower Gallery, Houston, TX  
*Art of War*, Poissant Gallery, Houston, TX  
*2007 – 20" x 20" x 20" Compact Competition*, LSU Union Art Gallery, Baton Rouge, LA  
*New Works, Jason Makepeace & Anthony Shumate*, Hardin Simmons University, Abilene, TX  
2006 *Sculpture Now, in the Houston Area*, Williams Tower Gallery, Houston, TX  
*Summer Juried Show*, The Arts Alliance of Clear Lake, Clear Lake, TX  
2005 *Texas Biennial 2005*, Dougherty Art Center, Austin, TX  
*New Work: Nina Craig and Jason Makepeace*, Artdust Gallery, Houston, TX  
*1st Annual Outdoor Sculpture Exhibition*, Montgomery College, Conroe, TX  
2004 *Preparatory Works*, Exhibition of the preparators of the Museum of Fine Arts, Houston and The Contemporary Art Museum, Curated by Clint Willour, The Jung Center, Houston, Texas and Galveston Art Center, Galveston, TX  
*Fellowship Series V: Abundance*, James Hill, Jason Makepeace, Brad Tucker, Space 125, CACHH (Community Art Council of Houston and Harris County), Houston, TX  
*Abstract Concepts*, The Art Center at the Opera House, Stephen F. Austin State University, Nacogdoches, TX,  
2003 *Mass In Between Void*, Harvey Bott, Dan Havel, Meredith Jack, Jason Makepeace, Patrick Rennner, Dean Ruck, Poissant Gallery, Houston, TX



## Continued Selected Group Exhibitions

- 2002 *Cody Bustamante & Jason Makepeace Exhibition*, University of Houston Clear Lake, Houston, TX  
*Collapse, Works by David Graeve & Jason Makepeace*, Fire Station #3, Houston, TX  
*Watermelon Flats*, BBAP Board exhibition, Art League, Houston, TX  
*Masters of Fine Arts Thesis Exhibition*, Blaffer Gallery the Art Museum of the University of Houston, Houston, TX  
*Recent Works*, Chenevert Green Studios, Houston, TX  
*Sculpture Vision, 10<sup>th</sup> Annual Outdoor Exhibition*, North Harris College, Houston, TX  
*Alter Ego*, Fire Station #3, Houston, TX  
*Items*, RAW Space, Houston, TX
- 2001 *Fire*, KGA Compound, Houston, TX  
*Abstraction/Subtraction*, Art Venture Gallery, Houston, TX  
*Sultry*, HCC Main Campus Gallery, Houston, TX  
*New Work, Jason Makepeace & David Medina*, HCC North Campus Gallery, Houston, TX  
*2001 Student Exhibition*, Blaffer Gallery, Houston, TX  
*eMotion Pictures: An Exhibition of Orthopedics in Art*, Herbst International Exhibition Hall, San Francisco, CA. (Exhibition traveled to Washington, DC & Chicago)  
*Collective Views*, Commerce Street Art Warehouse, Houston, TX
- 2000 *Outstanding Student Achievement in Contemporary Sculpture Exhibition*, Grounds for Sculpture, Hamilton, NJ  
*Fresh Mix*, The Community Artist Collective, Houston, TX  
*Revelation Texas*, Juried Exhibition, ARA Warehouse Gallery, Houston, TX
- 1999 *Art Crawl 99*, The Blue Warehouse Gallery, Houston, TX
- 1998 *Cortona Exhibition*, Group Exhibition, Lamar Dodd Gallery, Athens, GA
- 1997 *Mostra*, Group Exhibition, Via Signorelli Gallery, Cortona, Italy

## Fundraising Auctions/Exhibitions

- 1999-2012 *Annual Day of the Dead Retablo Exhibition*, Auction benefiting Lawndale Gallery, Houston, TX
- 2004-11 *2005, 5 x 7 Art Exhibition and Sale*, Arthouse at the Jones Center, Austin, TX
- 2001-09 *Art on the Avenue*, Auction benefiting Avenue CDC (Community Development Corporation), Winter Street Studios, Houston, TX
- 2008-09 *Float the Boat*, The Artist Boat Organization Annual Gala, Galveston, TX  
*Small Works by Great Minds Art Auction*, TAACCL (The Arts Alliance Center at Clear Lake), Clear Lake, TX
- 2008 *La Petite Mort-Mildred's Umbrella Gala*, The Gremillion and Company Gallery, Houston, TX

### Continued Fundraising Auctions/Exhibitions

- 2005-06 *Glassell-a-Go-Go*, 2005 Glassell School of Art Annual Benefit Auction, Houston, TX
- 2004 *Ricas Y famosas*, Spring Gala Silent Auction, Blaffer Gallery, Houston, TX  
*38 for XXXVIII*, Exhibition and Silent Auction benefiting The Cultural Arts Council of Houston and Harris County, Houston, TX
- 2003 *Imprint*, Exhibition and Silent Auction HSPVA Visual Art Department, Houston, TX
- 2001-09 *Art on the Avenue*, Auction benefiting Avenue CDC (Community Development Corporation), Winter Street Studios, Houston, TX
- 2001 *Xmas Tree Show*, Auction benefiting BBAP (Buffalo Bayou Art Park) Houston, TX
- 2000 *Holiday Art Sale*, benefiting BBAP (Buffalo Bayou Art Park) Houston, TX

### Selected Bibliography

- 2011 *DAY OF THE DEAD EYE ON ART Art Comes Alive Creativity Shines As Artists Make Most Of Day Geared To Respecting The Dead*, by Douglas Britt, Friday 10/28/2011 Houston Chronicle, Section Star, Page 1, 3 STAR Edition  
*Get Your Sneak Peek at Lawndale's Retablos Now*, Houston Press Blog, by Meredith Deliso, Wed., Oct. 19 2011  
*UHCL students make their own entry for Art Car Parade & UHCL art car makes impact at parade*, Bay Area Citizen, by Florian Martin May 11<sup>th</sup> & 24<sup>th</sup>, 2011
- 2010 *ISC Winners Now*, Sculpture Magazine, June 2010, 80.
- 2007 *Craftsmanship Always Impresses*, ACTS Studios Blog, Anthony Thompson Shumate
- 2006 *Man and Machine*, Egret, the magazine of University of Houston-Clear Lake, Karen Barbier, fall 2006, vol. 13, #1
- 2005 *The Front Row*, KUHF, Houston Public Radio, Meghan Hendley interview of Jason Makepeace: *Reconditioned* at Lawndale Art Center, Monday, August 29th  
*Texas Biennial 2005*, ARTLIES magazine, Rebecca S. Cohen, Spring 2005, vol.46  
*This Week's Day-by-Day Picks*, Houston Press, Steven Devadanam, Aug. 11, 2005
- 2004 *Jason Makepeace: what a wonderful toy*, ARTLIES magazine, John Devine, Fall 2004. vol.44  
*Preparatory Works*, ArtsHouston magazine, Christine Jelson West, June issue
- 2003 *In Between Mass and Void*, Houston Press, Kelly Klaasmeyer, Feb. 13th - 20th issues

### Continued Selected Bibliography

- 2002      *2002 Masters of Fine Arts Thesis Exhibition*, (exhibition catalog), Blaffer Gallery,  
            The Art Museum of the University of Houston  
*Expo MAG*, Houston's Digital Magazine for the Visual Arts, Houston, TX  
            Summer issue
- 2000      *2000 Outstanding Student Achievement in Contemporary Sculpture Award Exhibition*,  
            Sculpture Magazine, October 2000, issue pp. 38-43.

### Organizations

- 2011      Board Member, TAACCL (The Art Alliance Center of Clear Lake), Clear  
            Lake, TX
- 2008-11    UHCL's Faculty Advisor for The Art Association
- 2005-07    Programming Board Member, Lawndale Art Center, Houston, TX
- 2002-05    BBAP (Buffalo Bayou Art Park) President / Board member

### Conferences

- 2010      TASA (Texas Association of Schools of Art) Annual Conference, Austin,  
            TX, St. Edwards University
- 2001      18<sup>th</sup> International Sculpture Conference, ISC, Houston, TX
- 2000      Attended the *2000 International Sculpture Conference*, Houston, TX
- 1996      Attended Annual Iron Conference, Sloss Furnaces, Birmingham, AL

### Presentations & Workshop

- 2011      UHCL BFA Program and Sculpture Presentation and Workshop,  
            UHCL/University of Art Belgrade, Belgrade, Serbia, Oct. 11 – 18
- 2011      Sculpture Presentation and Portfolio reviews, UHCL/Universidad  
            Vercruzana, Xalapa, Mexico
- Slide Presentation, *Moldable Subtractions*, Lonestar College, Conroe, TX
- 2010      Art Consortium Workshop, UHCL/Universidad Vercruzana, Xalapa, Mexico
- 2007      Slide Presentation, *New Works, Jason Makepeace & Anthony Shumate*, Hardin  
            Simmons University, Abilene, TX
- 2003      Teen Council Lock-in at the Contemporary Art Museum, slide presentation  
            and discussion, Houston, TX
- 2002      *Sculpture Vision, 10<sup>th</sup> Annual Outdoor Exhibition, Slide Lecture*, North Harris  
            College, Houston, TX
- 2000      *Slide Jam*, slide presentation and discussion at the Contemporary Art  
            Museum, Houston, TX

## **Residencies/Registries/Juror**

- 2010           Invited Juror, Summer 2010 Open Juried Exhibition, TAACCL (The Arts Alliance Center at Clear Lake), Clear Lake, TX
- 2005           The Drawing Center's Viewing Program and Slide Registry, The Drawing Center, 35 Wooster Street, New York, NY 10013
- Invited Juror, Summer 2005 Open Juried Exhibition, TAACCL (The Arts Alliance Center at Clear Lake), Clear Lake, TX
- 2004           Edward Albee Foundation Fellow, The William Flanagan Creative Person Center Residence Program ("The Barn"), Montauk, NY

## **Current & Related Employment**

- 2011-12       Senior Lecturer in Art and Design, Full-time Sculpture Professor, Univ. of Houston Clear Lake, Houston, TX
- 2001-11       Sculpture Lecturer in Applied Design and Visual Art, University of Houston Clear Lake, Houston, Texas
- 2004-05       Museum Preparations, Museum of Fine Arts Houston, Houston, TX
- 2003           Artist Consultant, Floyd Newsum's *Metro-Rail Downtown Sculpture*, Houston, TX
- 2000-02       Joseph Havel/Ken King: Bronze Foundry, Houston, TX
- 1999           Gallery Preparation, Blaffer Gallery, Houston, TX
- Studio Assistant, Sharon Engelstein, Houston, TX
- 1997           Installation Assistant, *Grass Sod House*, by Herb Parker, Spoleto Art Festival, Charleston, SC
- 1995           Installation Assistant, *Progeny*, by Phyllis Constranich, Yvette Parker, and Robben McAdams, Spoleto Art Festival, Charleston, SC

## **Selected Collections**

Edward Albee, New York, NY  
Judy Breitenbach, Houston, TX  
Orna Feinstein, Houston, TX  
Houston's International Airport Art Collection, Houston, TX  
Ben and Caroline Jansen, Dickinson, TX  
Paul Kittelson and Carter Ernst, Houston, TX  
Judy Moon Kwon, Houston, TX  
Marshall and Victoria Lightman, Houston, TX  
MFAH (Museum of Fine Arts Houston), Houston, TX  
David Mackey, Houston, TX  
Lester Marks, Houston, TX  
Bob Perry, Houston, TX  
Anthony and Heather Podesta, Washington, DC  
Martha Terrill, Galveston, TX  
Christopher Thorpe, Houston, TX  
Fran and Don Walters, Houston, TX

