

Artist Currently Preparing Proposals
for Biomedical, Professional Precinct
and Stadium/Cougar Walk Projects

examples of previous projects by
artists

Kendall Buster

Health & Biomedical

last updated on August 17, 2010

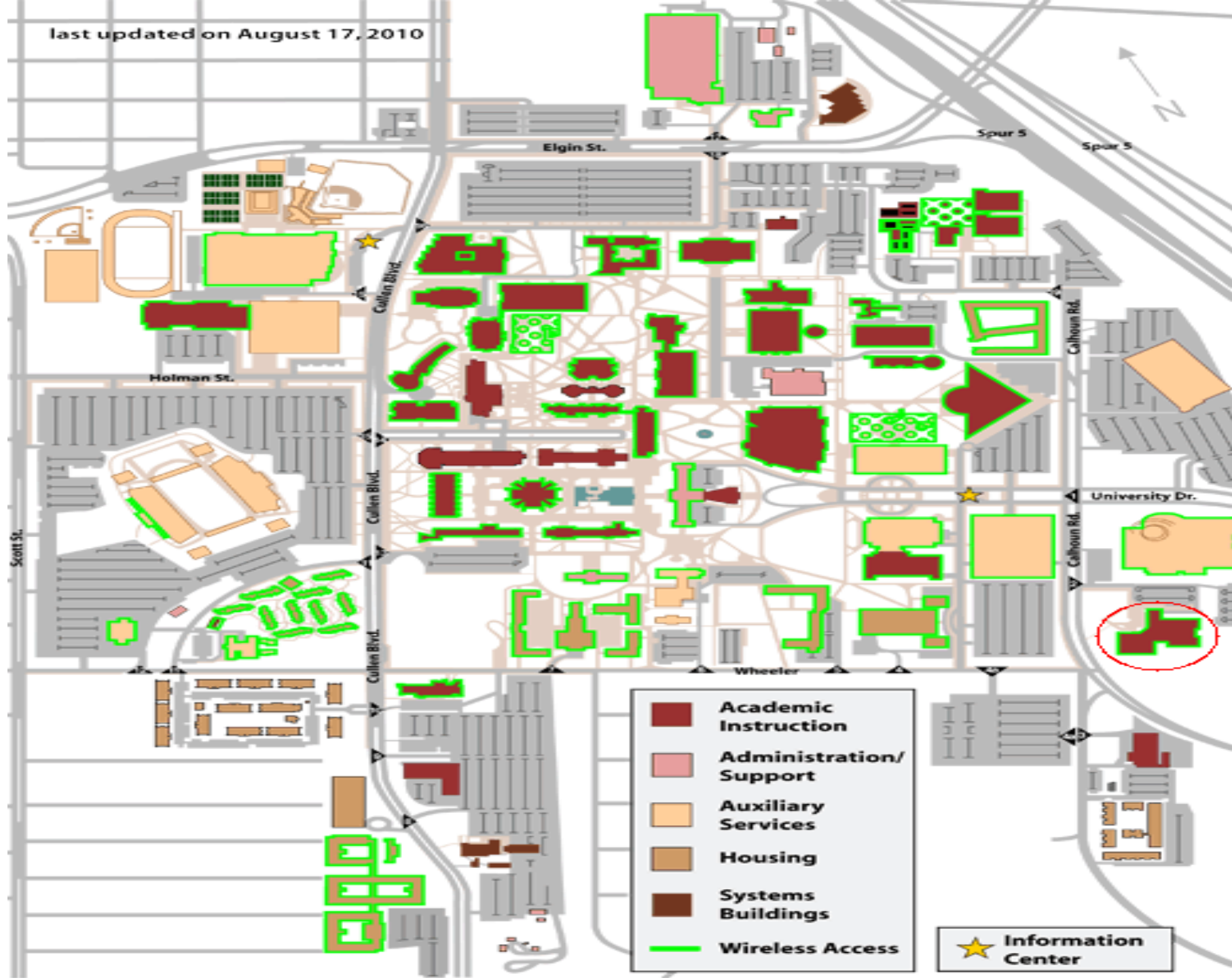



VESSEL FIELD, 2010

Vessel Field is a configuration of vessel-like forms suspended on stainless steel aircraft cable in the glass roof atrium of the renovated Gilman Hall at Johns Hopkins University in Baltimore, Maryland. The forms are constructed out of industrially powder-coated steel hollow tube covered in a white semi-transparent shade cloth. \$350,000.00 budget



RESONANCE, 2010

Resonance is a site-specific sculpture commissioned for The Frick Chemistry Lab at Princeton University. It was designed to converse with the particulars of the long and narrow sky-lit atrium space. The sculpture consists of six groupings of ovoid shaped forms suspended on stainless steel aircraft cable and attached to the structural steel beams of the building. Built with lightweight industrially powder-coated steel frames and covered in semi-transparent outdoor shade-cloth

New Growth/Stratum Model, 2009
Suyama Space, Seattle, WA
poly-carbonate plastic, aircraft cable



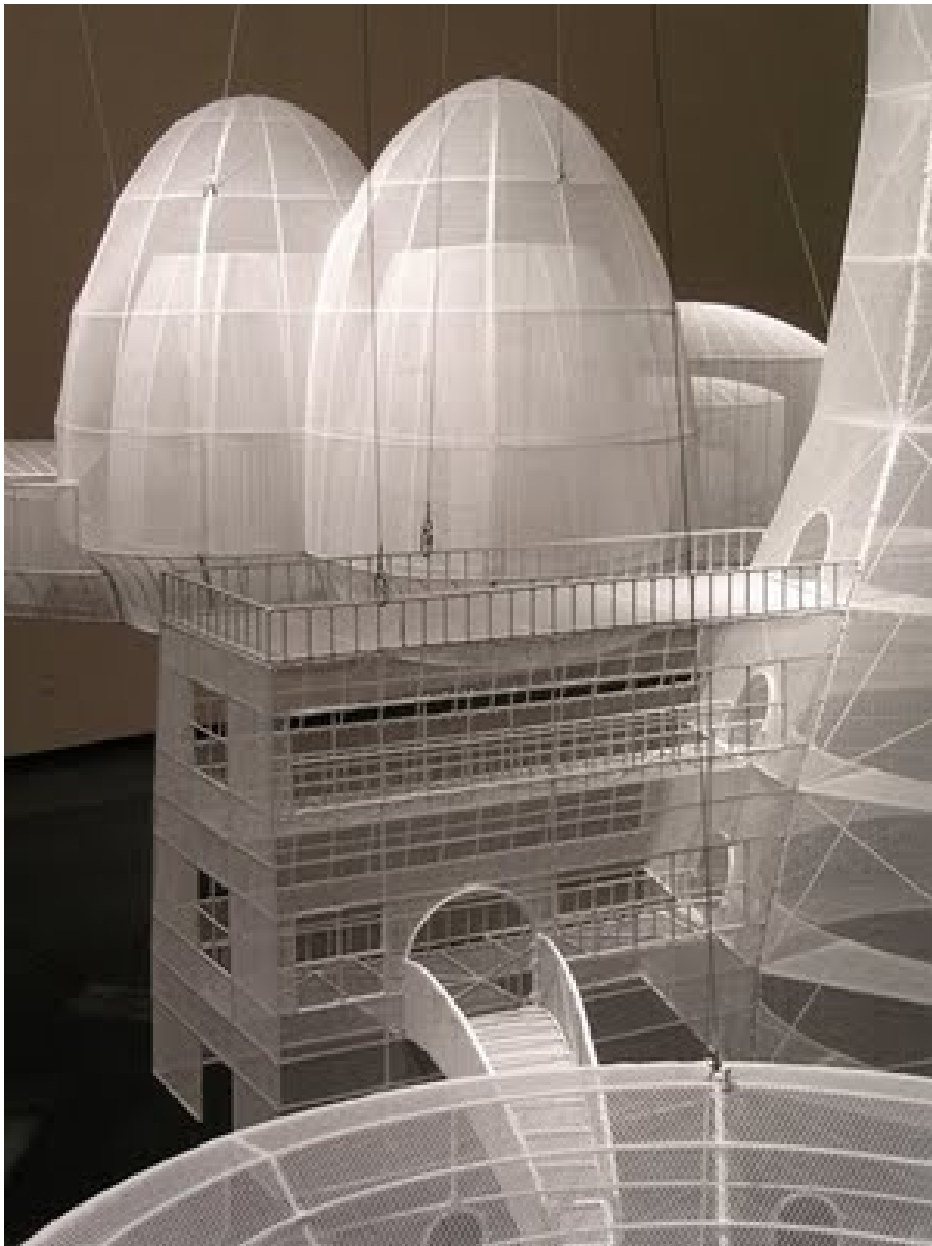

New Growth, 2007
Boise Art Museum, Boise, ID
shadecloth, steel

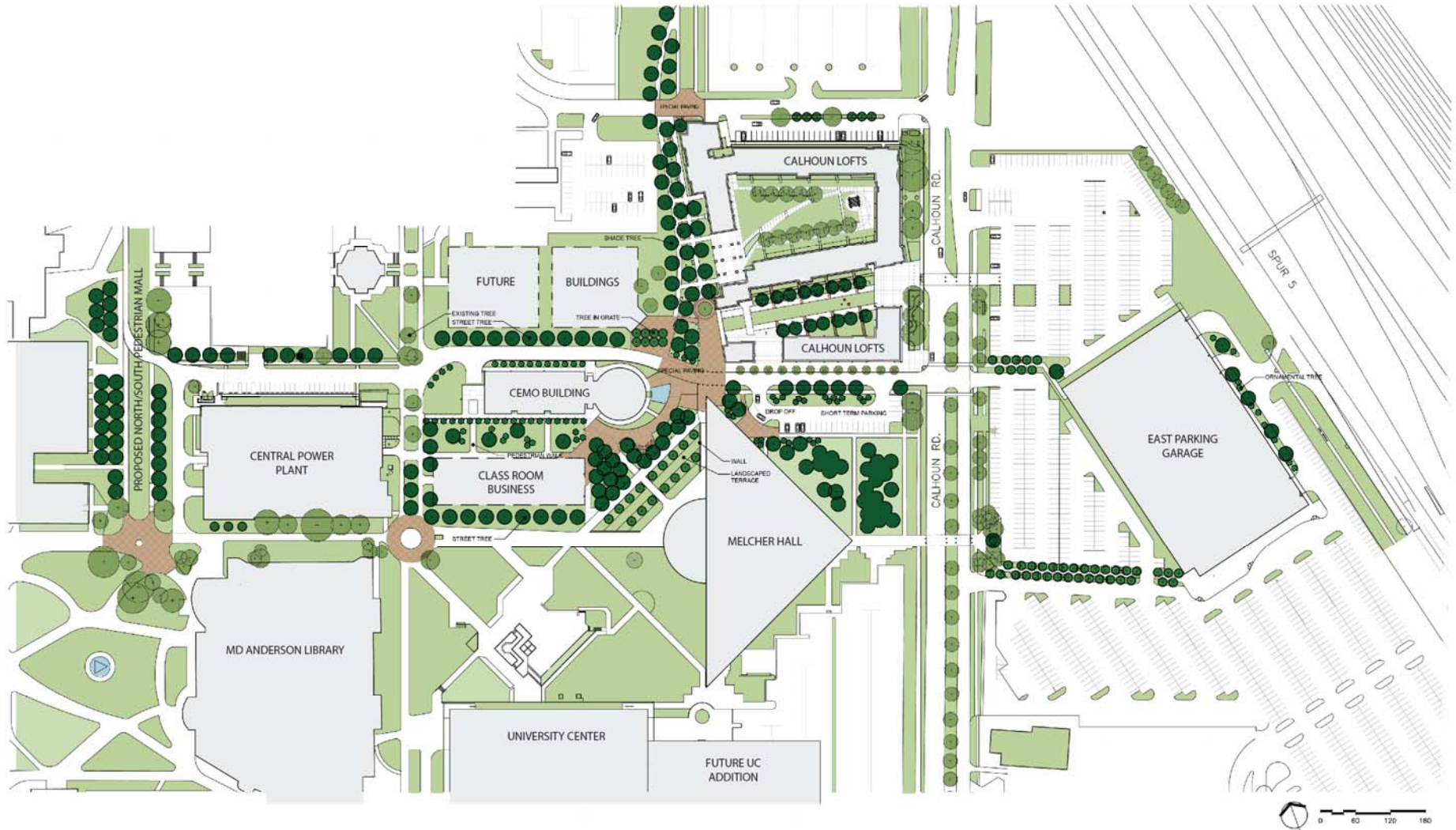

THIS DRAWING IS CONCEPTUAL IN NATURE AND IS SUBJECT TO CHANGE.
NO WARRANTIES OR REPRESENTATIONS, EXPRESSED OR IMPLIED, CONCERNING
THE ACTUAL DESIGN, LOCATION OR CHARACTER OF THIS PLAN ARE INTENDED.
THIS PLAN IS NOT FOR PERMIT OR CONSTRUCTION PURPOSES.

PRELIMINARY DESIGN
MAY 4, 2010
CCA PROJECT NO. 109-073

UNIVERSITY OF HOUSTON

Professional District
Landscape Improvements
University of Houston
Houston, TX



**CLARK CONDON
ASSOCIATES**
LANDSCAPE ARCHITECTURE

10401 Sheila Link Road Houston, Texas 77025
TEL: 713.871.1111 FAX: 713.871.0888
www.clarkcondon.com

Brian Tolle

Professional Precinct

Stronghold, mixed media, 2008, University of Washington
30 x 30 x 5 ft., Red cedar





*For the Gentle Wind Does Move
Silently, Invisibly*, University at
Buffalo, 2004-07

Styrofoam, steel, paint
urethane

11 x 4 x 6 ft. each

Originally sited in Cleveland,
OH

Twisted Chimney, brick, 2010, Wales



Irish Hunger Memorial, 2002
Battery Park City, NY





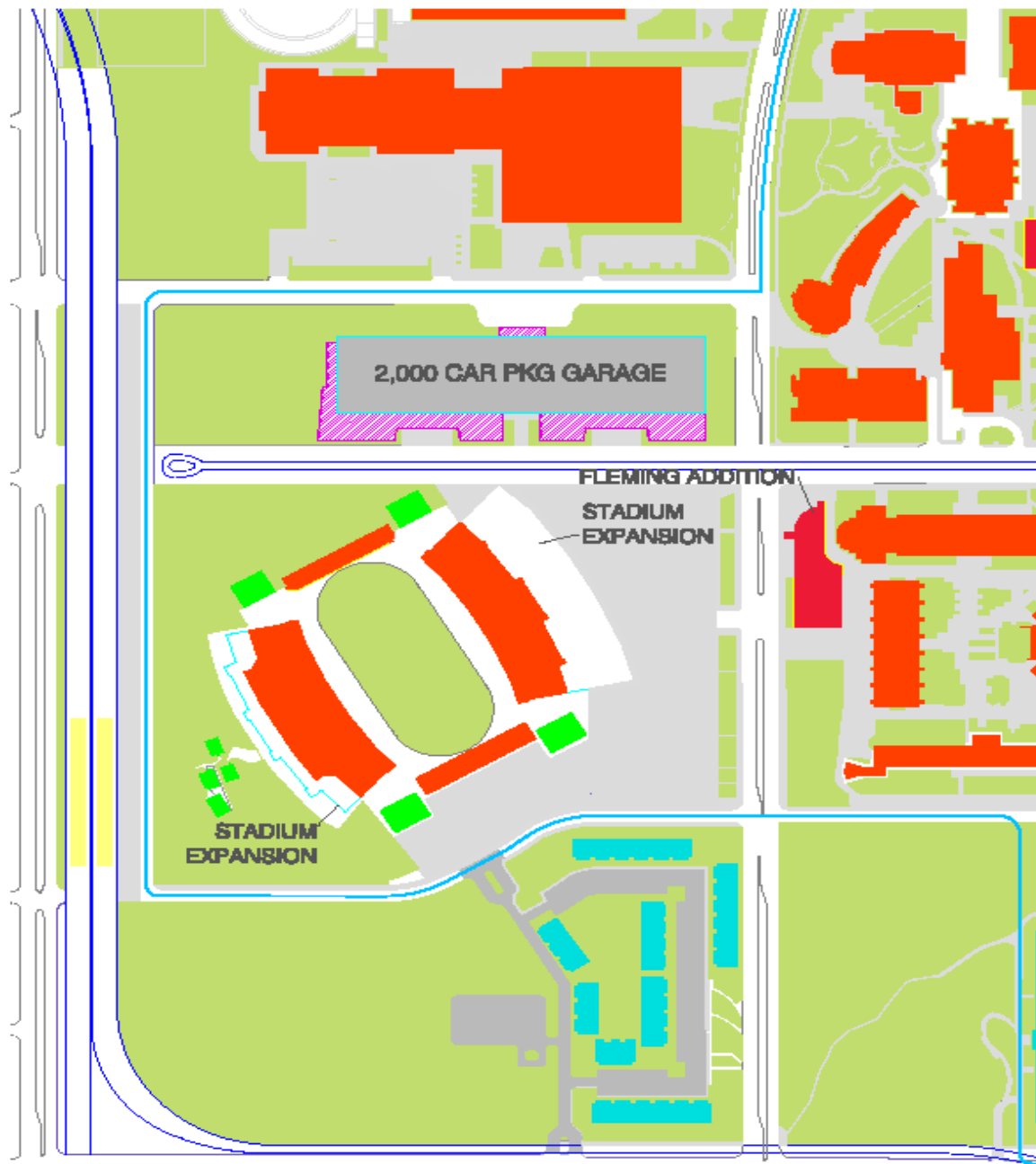

Liam Gillick

Stadium/Cougar Walk

Linked Projection, 2010 steel, glass, 75 x 25 x 11 ft., Forsyth Court, Centene Plaza,
Clayton, MO





Lufthansa Headquarters, Frankfurt,
2006, powder coated aluminum text





Home Office, London, 2002-05,
façade details



Jim Isermann

Stadium/Cougar Walk

MTA, CA, 2006, 459 powder coated aluminum panels and steel uni-strut. overall approximately 14" x 125'



5 Pendant Chandelier: Powder coated aluminum, steel and polycarbon. Carpet tile: Wet-dye injection printed tufted nylon and polyurethane backing. UC San Francisco, 2003





Dallas Cowboys Stadium, 2009-10



73 POWDER COATED STEEL AND ALLUMINUM MODULES, LED ILLUMINATION. EACH MODULE
INSTALLED AT THE UCR GENOMIC BUILDING: INSTITUTE FOR INTEGRATIVE GENOME BIOLOGY,
2009



Current and Former Faculty Artwork Purchases

Luis Jimenez, *Fiesta Dancers*, 1996, fiberglass, 114 x 96 x 59 in.



last updated on August 17, 2010

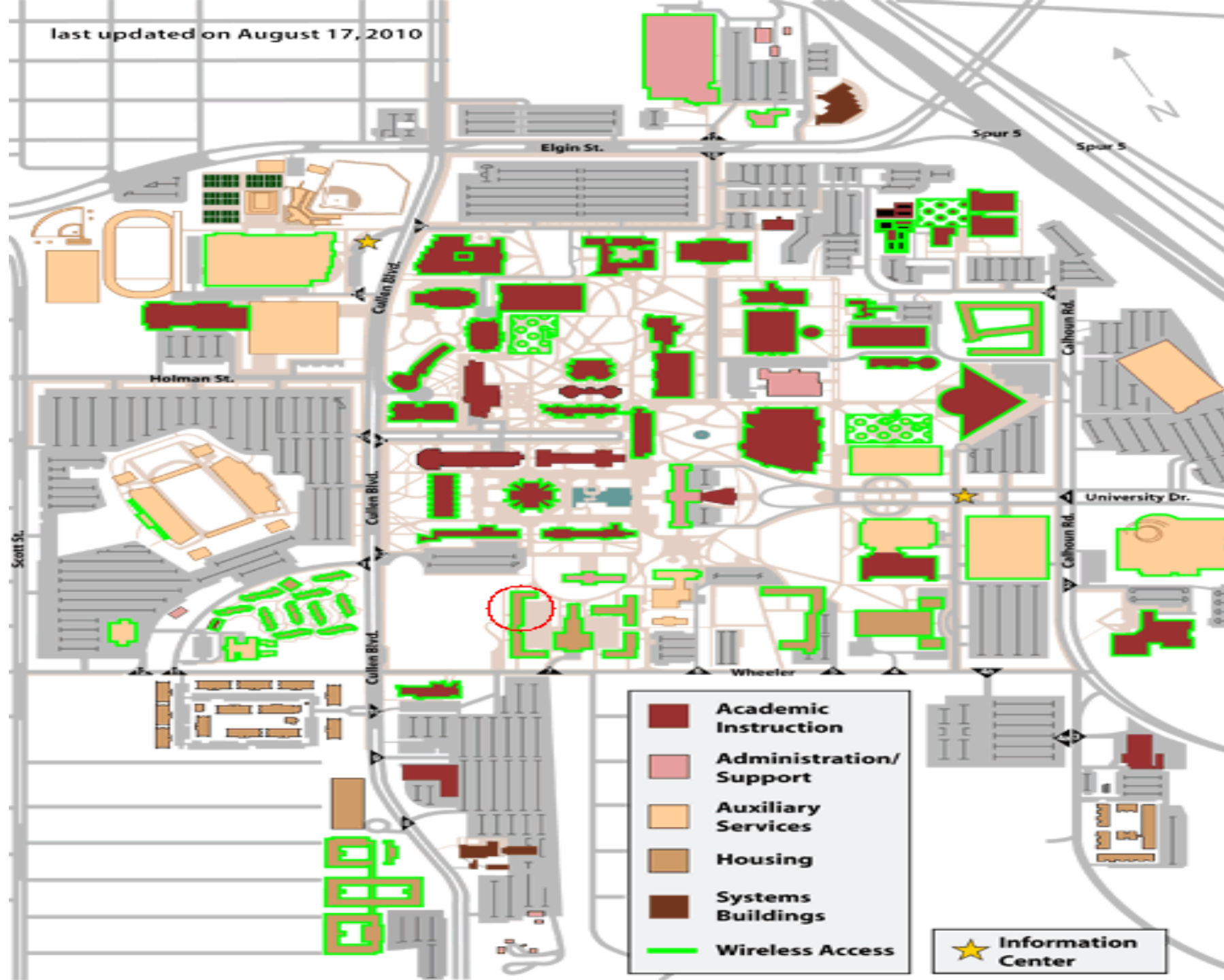

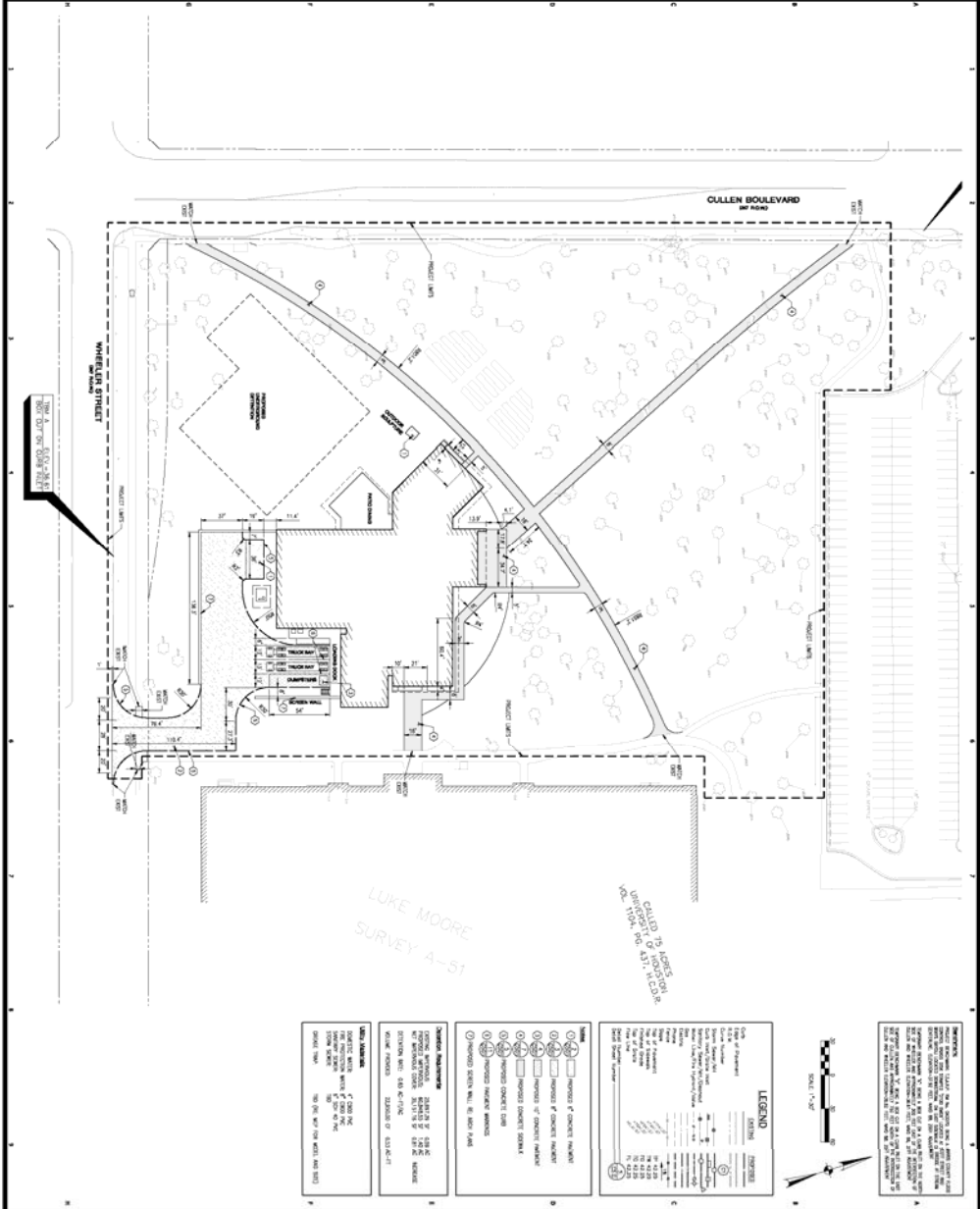

LUKE MOORE
SURVEY A-51

CALLED TO RECORD
UNIVERSITY OF HOUSTON,
431, 1/1/2017

LEGEND

EXISTING

- 1" = 100'
- 1" = 200'
- 1" = 300'
- 1" = 400'
- 1" = 500'
- 1" = 600'
- 1" = 700'
- 1" = 800'
- 1" = 900'
- 1" = 1000'

LEGEND

- 1" = 100'
- 1" = 200'
- 1" = 300'
- 1" = 400'
- 1" = 500'
- 1" = 600'
- 1" = 700'
- 1" = 800'
- 1" = 900'
- 1" = 1000'

LEGEND

- 1" = 100'
- 1" = 200'
- 1" = 300'
- 1" = 400'
- 1" = 500'
- 1" = 600'
- 1" = 700'
- 1" = 800'
- 1" = 900'
- 1" = 1000'

UNIVERSITY OF HOUSTON
WEST DINING HALL
HOUSTON, TEXAS

REVISIONS

NO.	DATE	DESCRIPTION
1	10/20/2017	ISSUED FOR PERMIT

PROJECT INFORMATION

PROJECT: UNIVERSITY OF HOUSTON WEST DINING HALL
OWNER: UNIVERSITY OF HOUSTON
ARCHITECT: LUKE MOORE
DATE: 10/20/2017

SCALE

1" = 100'

WALTER P. MOORE

REGISTERED PROFESSIONAL ENGINEER
NO. 10000
EXPIRATION DATE: 12/31/2020

UNIVERSITY OF HOUSTON

1600 UNIVERSITY BLVD.
HOUSTON, TEXAS 77002



Al Souza
Windows on the World,
2005
Collaged puzzle pieces
72 in. diameter



Gael Stack
Untitled, 2008
Oil on canvas
84 x 64 in.

MANUAL (Hill/Bloom)

La Musique, 2011

Archival pigment print, ed: 5

18 x 62"



MANUAL (Hill & Bloom)

Oliver Twist, 2010

archival pigment print, ed: 2/5

16 1/2" x 21"

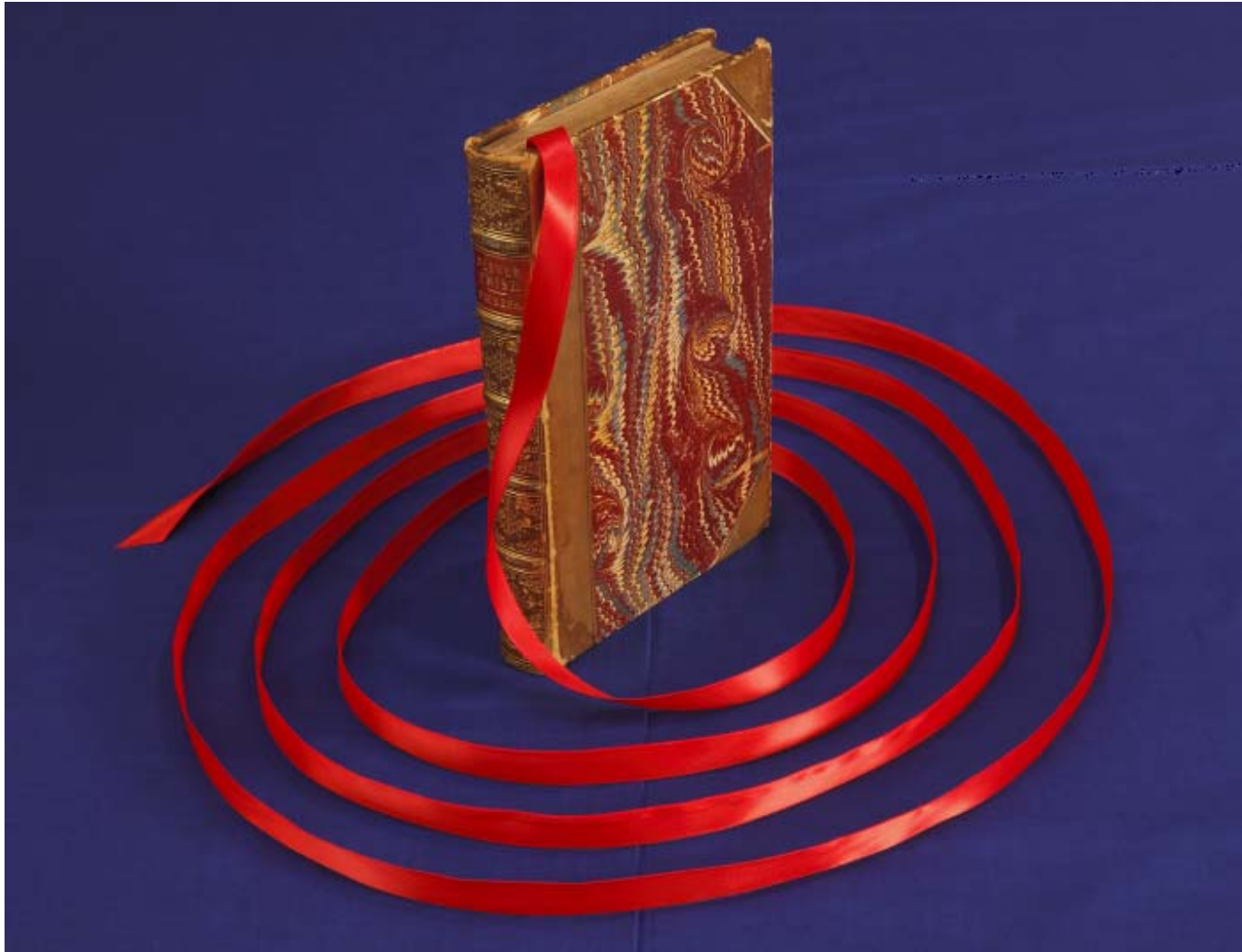

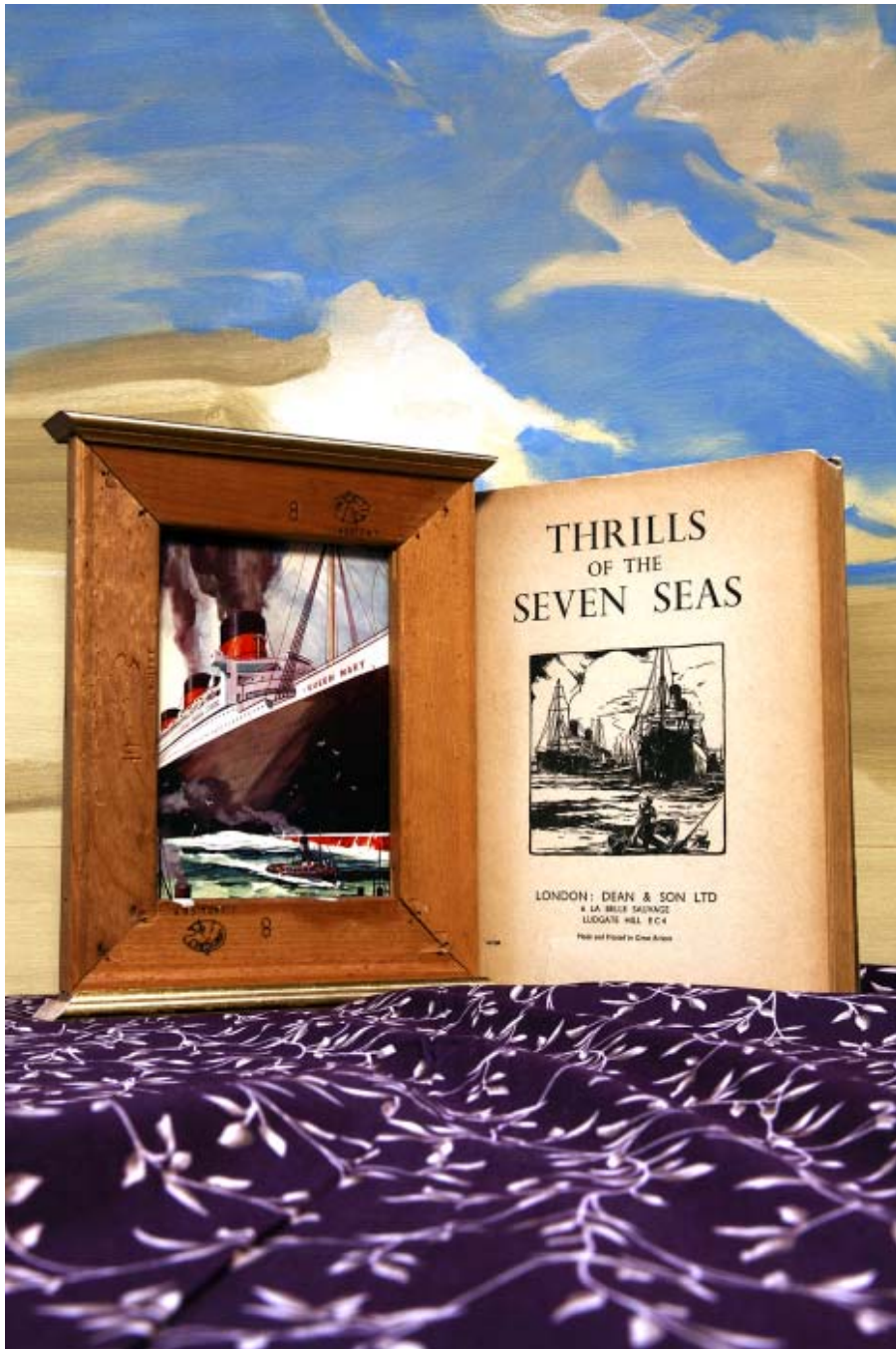

- MANUAL (Hill & Bloom)
- *Thrills*
- 2010
- archival pigment print, ed: 4/5
- 26" x 17"

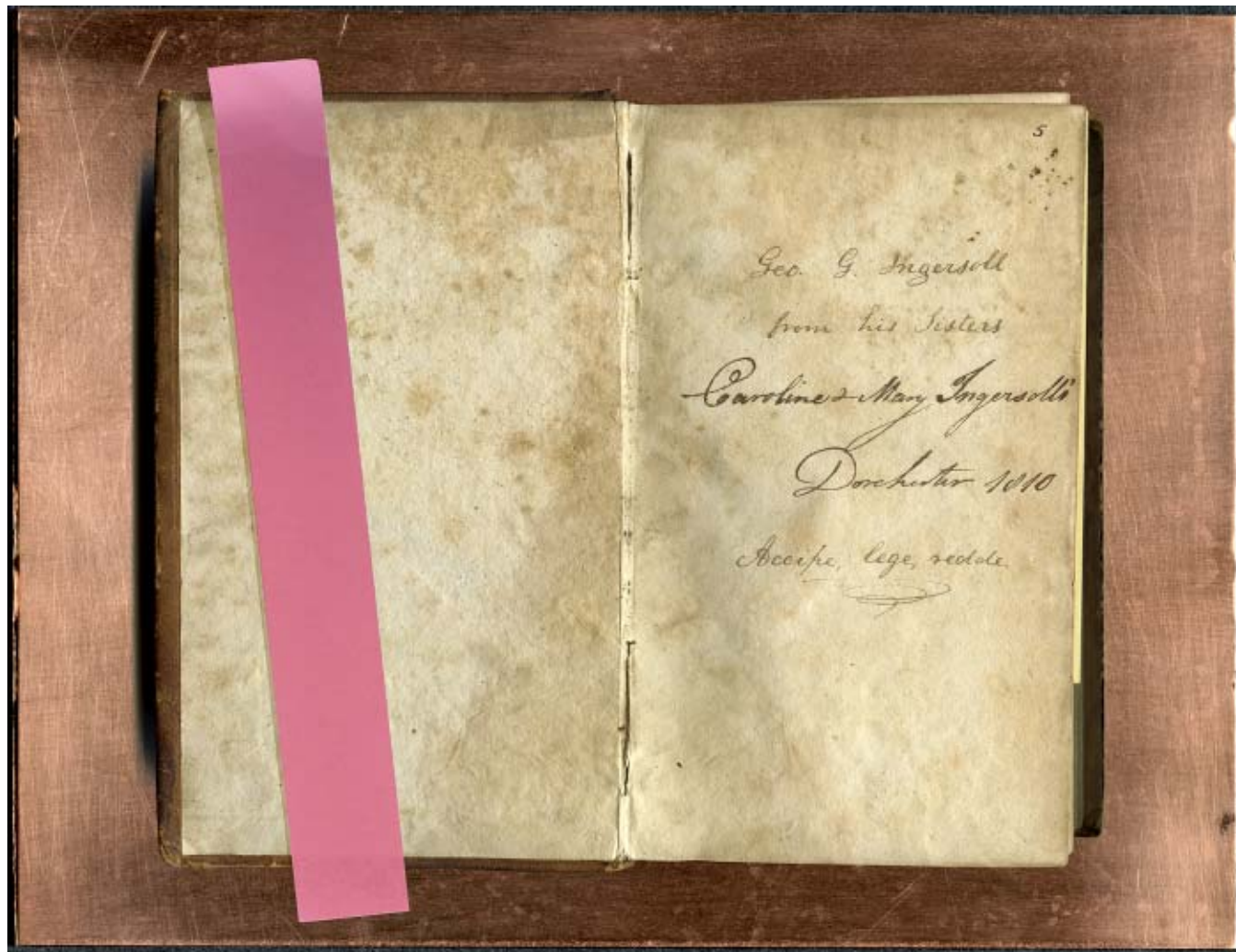

MANUAL (Hill &
Bloom)

Kett's Elements

2010

archival pigment

print, ed: 2/3

34 1/2" x 44"

MANUAL (Hill & Bloom)

Goya and the Impossible Revolution

2010

archival pigment print, ed: 2/5

17" x 26"



MANUAL (Hill & Bloom)
Still Life in the Dutch Manner
2010
archival pigment print, ed: 1/3
27 1/2" x 39 1/4"



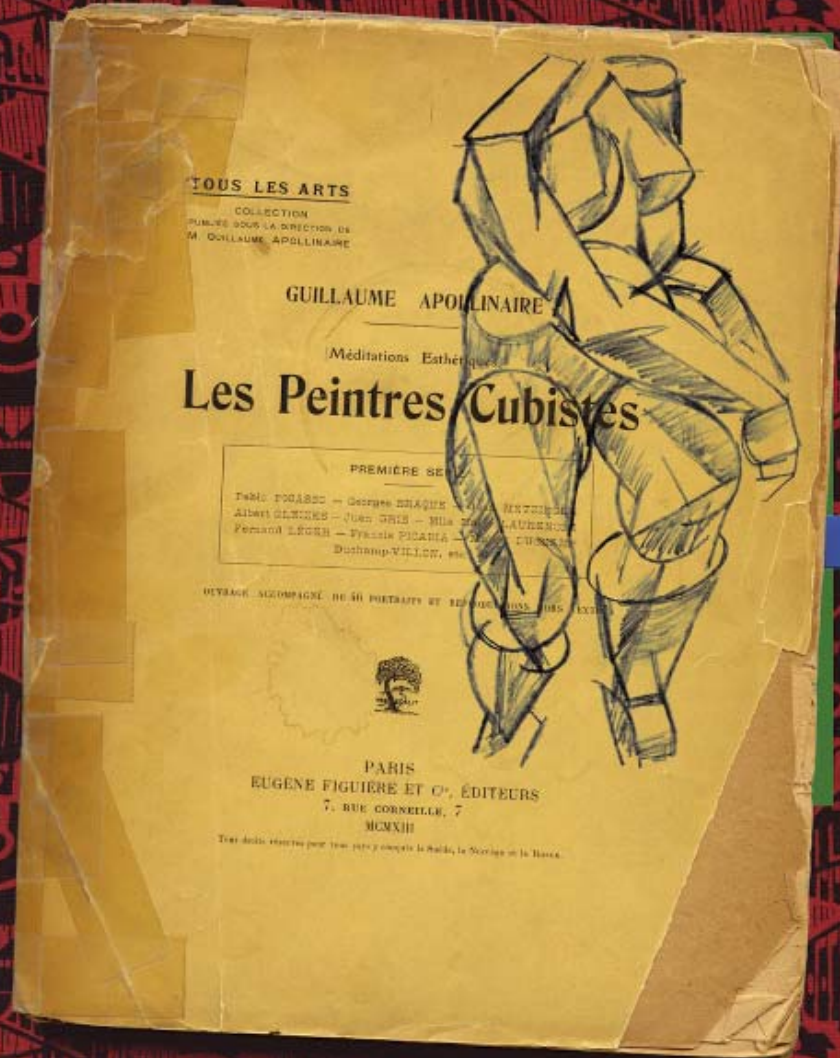

MANUAL (Hill & Bloom)
*Les Cubistes: The Russian
Invasion*

2010

archival pigment print, ed: A/P,
from edition of 3
44 1/4" x 39"

MANUAL (Hill & Bloom)

Adventures

2010

archival pigment print, ed: 1/5

22 1/2" x 32"





MANUAL (Hill & Bloom)

Number Two

2010

archival pigment print, ed: 1/5

21 1/2" x 16 1/2"

MANUAL (Hill & Bloom)

Atlas Shredded

2010

archival pigment print, ed: 2/5

17" x 22"

